



AttiCat™

EXPANDING BLOWN-IN
INSULATION SYSTEM



R Value	R12	R20	R24	R28	R32	R36	R40	R50	R60
Blown inches	4.5	7.5	9.0	10.5	12.0	13.5	14.75	18.5	22.25
Coverage/bag (ft²)	162.9	97.8	81.5	69.8	61.1	54.3	48.9	39.1	32.6
Number of 30 lb/13.6 kg AttiCat™ Bags required									
SQ. FT.	R12	R20	R24	R28	R32	R36	R40	R50	R60
500	3.1	5.1	6.1	7.2	8.2	9.2	10.2	12.8	15.3
600	3.7	6.1	7.4	8.6	9.8	11.0	12.3	15.3	18.4
700	4.3	7.2	8.6	10.0	11.5	12.9	14.3	17.9	21.5
800	4.9	8.2	9.8	11.5	13.1	14.7	16.4	20.5	24.5
900	5.5	9.2	11.0	12.9	14.7	16.6	18.4	23.0	27.6
1000	6.1	10.2	12.3	14.3	16.4	18.4	20.4	25.6	30.7
1100	6.8	11.2	13.5	15.8	18.0	20.3	22.5	28.1	33.7
1200	7.4	12.3	14.7	17.2	19.6	22.1	24.5	30.7	36.8
1300	8.0	13.3	16.0	18.6	21.3	23.9	26.6	33.2	39.9
1400	8.6	14.3	17.2	20.1	22.9	25.8	28.6	35.8	42.9
1500	9.2	15.3	18.4	21.5	24.5	27.6	30.7	38.4	46.0
1600	9.8	16.4	19.6	22.9	26.2	29.5	32.7	40.9	49.1
1700	10.4	17.4	20.9	24.4	27.8	31.3	34.8	43.5	52.1
1800	11.0	18.4	22.1	25.8	29.5	33.1	36.8	46.0	55.2
1900	11.7	19.4	23.3	27.2	31.1	35.0	38.9	48.6	58.3
2000	12.3	20.4	24.5	28.7	32.7	36.8	40.9	51.2	61.3

At The Machine (Person #1)

SETUP

- 1** Assemble machine.
Run hose to attic.

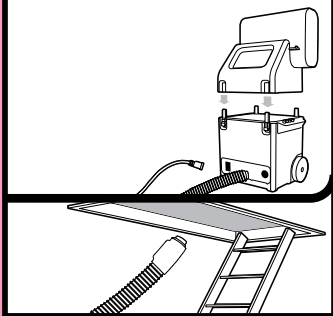

- 2** Cut bags in half.

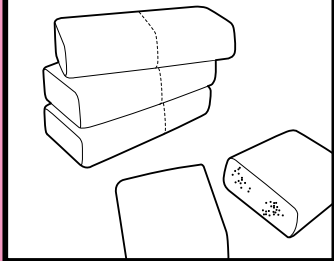

USE

- 3** Push half bag into machine.

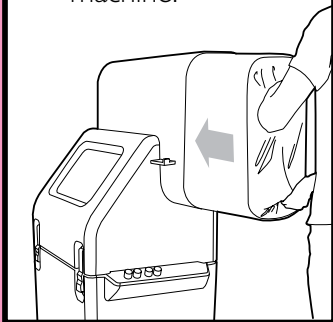

- 4** Remove packaging.

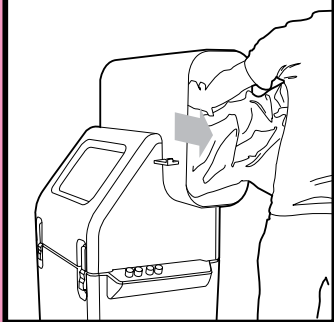

In The Attic (Person #2)

SETUP

- 1** Install rulers.

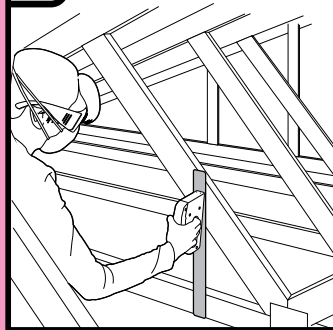

- 2** Install eaves baffles
and rigid barrier.

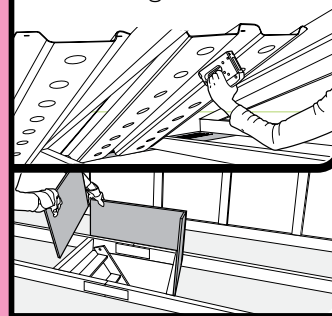

USE

- 3** Push remote
"START" button to
start the machine.

