



## Evaluation Report CCMC 12935-R FOAMULAR® CodeBord® Air Barrier System (CABS)

<b>MASTERFORMAT:</b>	07 27 09.01
<b>Evaluation issued:</b>	2000-01-24
<b>Re-evaluated:</b>	2016-01-07
<b>Re-evaluation due:</b>	2018-01-24

### 1. Opinion

It is the opinion of the Canadian Construction Materials Centre (CCMC) that “FOAMULAR® CodeBord® Air Barrier System (CABS)”, when used as an air barrier system in accordance with the conditions and limitations stated in Section 3 of this Report, complies with the National Building Code 2010:

- Clause 1.2.1.1.(1)(b), Division A, as an alternative solution that achieves at least the minimum level of performance required by Division B in the areas defined by the objectives and functional statements attributed to the following applicable acceptable solutions:
  - Subsection 5.4.1., Air Barrier Systems
  - Subsection 9.25.3., Air Barrier Systems

This opinion is based on CCMC’s evaluation of the technical evidence in Section 4 provided by the Report Holder.

Ruling No. 09-39-237 (12935-R) authorizing the use of this product in Ontario, subject to the terms and conditions contained in the Ruling, was made by the Minister of Municipal Affairs and Housing on 2009-12-30 pursuant to s.29 of the Building Code Act, 1992 (see Ruling for terms and conditions). This Ruling is subject to periodic revisions and updates.

### 2. Description

This report addresses the performance of the product as an air barrier system as specified by Owens Corning. The product consists of the following components and accessories (see Figure 1) providing the following functions:

- Plane of airtightness: “FOAMULAR® CodeBord®” extruded polystyrene (XPS), Type 3 (see CCMC 13431-L) as the principal material in the plane of airtightness. Minimum of 20-mm thickness for studs at 400 mm (16 in.) on centre (o.c.) and minimum 25-mm thickness for studs at 600 mm (24 in.) o.c.
- Continuity: Accessories for continuity include two approaches:
  - For Original “CABS”:**
    - “FoamSealR™,” a foamed polyethylene sealing gasket installed behind all (i.e., vertical and horizontal) “FOAMULAR® CodeBord®” XPS panel joints, and also at XPS panel termination points around penetrations such as around windows and doors;
  - For Hybrid “CABS”:**
    - “FoamSealR™,” a foamed polyethylene sealing gasket installed behind “FOAMULAR® CodeBord®” XPS horizontal joints at the perimeter of the uppermost top plate (i.e., top floor) and the bottom of the lowermost floor perimeter (i.e., along header) only, and around windows and doors;
    - CCMC-evaluated “OC JointSealR® Foam Joint Tape” (CCMC 14003-R) to seal horizontal and vertical joints of the XPS panels; and
    - CCMC-evaluated “OC FlashSealR® Foam Flashing Tape” (CCMC 14003-R) to seal around window and door openings, in lieu of “FoamSealR™” foam gaskets. A combination of specified gasket and tape can also be used as per the manufacturer’s details.

**For both Original and Hybrid “CABS”:**

- sealant foam that is a one-component, spray-in-place polyurethane evaluated by CCMC (see CCMC 13074-L) or meeting CAN/ULC-S710.1-05, “Standard for Thermal Insulation – Bead-Applied One Component Polyurethane Air Sealant Foam, Part 1: Material Specification,” and CAN/ULC-S710.2-05, “Standard for Thermal Insulation – Bead-Applied One Component Polyurethane Air Sealant Foam, Part 2: Installation.” The sealant must have qualified for sealing the two relevant contact surfaces around penetrations to be sealed, covering vinyl and wood as a minimum (i.e., for sealing wood rough opening and vinyl window), but preferably also XPS and galvanized metal;
  - 4-mil polyethylene as the designated ‘vapour barrier’ only (i.e., unsealed joints), compliant with Subsection 9.25.4., Vapour Barriers, of Division B of the NBC 2010;
  - 6-mil polyethylene air/vapour barrier conforming to CAN/CGSB-51.34-M86, “Vapour Barrier, Polyethylene Sheet for Use in Building Construction,” installed at ceiling locations and on the interior where specified in the “CABS” for the continuity of the plane of airtightness; and
  - specified caulking sealants conforming to CAN/CGSB-19.0-M77, “Methods of Testing Putty, Caulking and Sealing Compounds.”
- Strength: Specified cap nails and nailing schedule to provide the strength to resist wind loads in low-rise buildings achieved by fastening the “CABS” to the supporting structure.

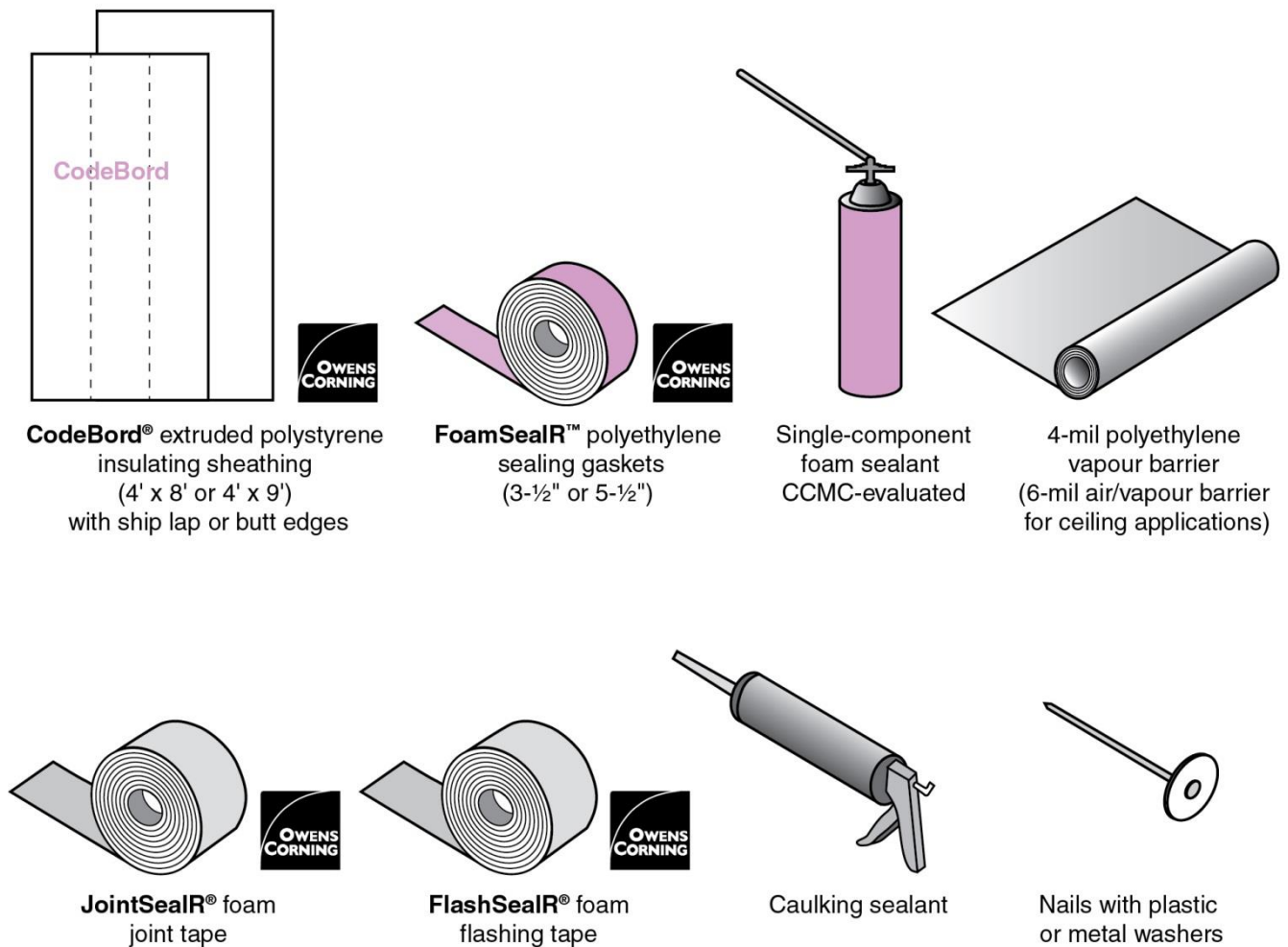

**Figure 1. Components and accessories used for the in-field installation of the product**

### 3. Conditions and Limitations

CCMC’s compliance opinion in Section 1 is bound by the “FOAMULAR® CodeBord® Air Barrier System (CABS)” being used in accordance with the conditions and limitations set out below.

- The “CABS” has demonstrated sufficiently low air permeance in accordance with NBC 2010 for buildings with an indoor environment of 20°C and winter design relative humidity (RH) of 35% or less.
- The “CABS” has demonstrated sufficient strength to be used in low-rise buildings in geographical locations:
  - i. where the  $Q_{50} \leq 0.75$  kPa (1-in-50 year return period found in Appendix C of the NBC 2010), for the 20-mm-thick XPS on studs at 400 mm (16 in.) o.c., for maximum building height of 20 m, and
  - ii. where the  $Q_{50} \leq 0.55$  kPa, for the 25-mm-thick XPS on studs at 600 mm (24 in.) o.c., for a maximum building height of 12 m.
- For conforming air leakage control and strength, the “CABS” must be installed:
  - with the minimum specified thickness for the respective stud spacing over wood-frame walls; and
  - installed in the field by Owens Corning-trained installers/contractors according to the Owens Corning “FOAMULAR® CodeBord® Air Barrier System (CABS)” installation manual, publication no.300494, dated 2011, which contains detailed construction drawings which must be followed for the original CABS and alternative details (Section 6-1), and also “FOAMULAR® CodeBord® Air Barrier System Illustrative Guide”, pub. No. 500668, dated June 2014 for installation of the hybrid system (see Appendix A for examples).
- A copy of the installation instructions must be available on the job site at all times during the installation for review by building officials. All installers must present their identification card upon request by the building official.

### 4. Technical Evidence

The Report Holder has submitted technical documentation for CCMC’s evaluation. Testing was conducted at laboratories recognized by CCMC. The corresponding technical evidence for this product is summarized below.

The product has demonstrated performance that meets the criteria of the CCMC Technical Guide. To qualify, a conforming air barrier system must:

- i. have an acceptable low air leakage rate;
- ii. be continuous;
- iii. be durable;
- iv. have sufficient strength to resist the anticipated air pressure load; and
- v. be buildable in the field.

**Table 4.1.1 Results of Testing of Air Leakage Rate of the Product**

Wood-Frame Walls		Requirement	Result
Original “CABS” (25-mm “FOAMULAR® CodeBord®” XPS with foam gaskets beneath XPS panel joints)	Specimen no. 1 – opaque wall	Air leakage rate <sup>2</sup> at 75 Pa $\Delta P \leq 0.05$ L/(s·m <sup>2</sup> )	0.048 L/(s·m <sup>2</sup> ) <sup>3</sup>
	Specimen no. 2 – continuity at penetrations		
	Specimen no. 3 – continuity at foundation and brick straps		
Hybrid “CABS” (20-mm “FOAMULAR® CodeBord®” XPS(R4) with exterior taped seams)	Specimen no. 1 – opaque wall	Air leakage rate <sup>2</sup> at 75 Pa $\Delta P \leq 0.05$ L/(s·m <sup>2</sup> )	0.042 L/(s·m <sup>2</sup> ) <sup>3</sup>
	Specimen no. 2 – continuity at penetrations, foundation, brick straps		
Hybrid “CABS” (25-mm “FOAMULAR® CodeBord®” XPS(R5) with exterior taped seams)	Specimen no. 1 – opaque wall	Air leakage rate <sup>1</sup> at 75 Pa $\Delta P \leq 0.05$ L/(s·m <sup>2</sup> )	0.040 L/(s·m <sup>2</sup> ) <sup>3</sup>
	Specimen no. 2 – continuity at penetrations, foundation, brick straps		

#### Notes to Table 4.1.1:

- 1 The air leakage rate of the specimens is determined after structural aging of the air barrier system. Aging of the air barrier system was conducted to qualify it for a design structural wind load of  $Q_{50} = 0.55$  kPa (NBC climatic data in Appendix C) for a 1-in-50 year return period. The air barrier system was subjected to a loading schedule involving one-hour sustained positive and negative pressure set at 0.55 kPa, 2 000 cycles of positive and negative pressure set at 0.80 kPa, and a wind gust of positive and negative pressure set at 1.2 kPa. The air leakage rate was determined in accordance with ASTM E 1424-91(2008), “Determining the Rate of Air Leakage Through Exterior Windows, Curtain Walls, and Doors Under Specified Pressure and Temperature Differences Across the Specimen,” at an air temperature of –20°C to verify any deformation causing leakage at low temperatures.
- 2 The air leakage rate of the specimens is determined after structural aging of the air barrier system. Aging of the air barrier system was

conducted to qualify it for a design structural wind load of  $Q_{50} = 0.75$  kPa (NBC climatic data in Appendix C) for a 1-in-50 year return period. The air barrier system was subjected to a loading schedule involving one-hour sustained positive and negative pressure set at 0.75 kPa, 2 000 cycles of positive and negative pressure set at 1.210 kPa, and a wind gust of positive and negative pressure set at 1.810 kPa. The air leakage rate was determined in accordance with ASTM E 1424-91(2008), “Determining the Rate of Air Leakage Through Exterior Windows, Curtain Walls, and Doors Under Specified Pressure and Temperature Differences Across the Specimen,” at an air temperature of  $-20^{\circ}\text{C}$  to verify any deformation causing leakage at low temperatures.

- 3 The air leakage performance results in a Classification A1 as per CAN/ULC-S742-11, “Standard for Air Barrier Assemblies – Specification.” The air leakage rate criteria is based on the permissible air leakage rates shown in Table 4.1.2, which are considered to be in accordance with the NBC in regards to air barrier system performance and drying potential of the wall assembly

**Table 4.1.2 Permissible Air Leakage Rates**

Drying Potential Based on Water Vapour Permeance (WVP) of Outermost Layer of Wall Assembly ( $\text{ng}/\text{Pa}\cdot\text{s}\cdot\text{m}^2$ )	Maximum Permissible Air Leakage Rates ( $\text{L}/\text{s}\cdot\text{m}^2$ ) @ 75 Pa
$15 < \text{WVP}^1 \leq 60$	0.05 <sup>1</sup>
$60 < \text{WVP} \leq 170$	0.10
$170 < \text{WVP} \leq 800$	0.15
$> 800$	0.20

**Note to Table 4.1.2:**

- 1 As the “FOAMULAR® CodeBord®” extruded polystyrene is less than  $60 \text{ ng}/\text{Pa}\cdot\text{s}\cdot\text{m}^2$  (for a 20-mm thickness,  $\text{WVP} = 50 \text{ ng}/\text{Pa}\cdot\text{s}\cdot\text{m}^2$ ), this air leakage requirement must be met. However, due to the reduction in the risk of condensation from the insulation value, the air leakage rate could be increased by  $0.05 \text{ L}/\text{s}\cdot\text{m}^2$  if the thermal resistance “FOAMULAR® CodeBord®” meets the requirements of Table 9.25.5.2., Ratio of Outboard to Inboard Thermal Resistance, of Division B of the NBC 2010.

**Table 4.1.3 Results of Testing of Durability of Components of the Product**

Component		Requirement	Result
Original “CABS”	“FOAMULAR® CodeBord®”	Air permeance before and after aging (ASTM D 726-84) $< 10\%$ increase	Passed <sup>1</sup>
		Thermal resistance after heat aging and weathering $90\%$ retention	Passed
	“FoamSealR™” polyethylene sealing gasket	Oxidative induction time (OIT) $\geq 30$ minutes	Passed
	proprietary spray-in-place foam sealant	Air leakage after aging $\leq 0.5 \text{ L}/\text{s}$ at 75 Pa $\Delta P$	Passed
	caulking sealant for protection from weather	Meets CAN/CGSB-19.0-M77	Not evaluated for durability of air leakage performance
Hybrid “CABS”	“FOAMULAR® CodeBord®”	Air permeance before and after aging as per ULC S741 aging (i.e., 28 cycles of UV exposure + heat aging 772 h at $50^{\circ}\text{C}$ ) $< 10\%$ increase	Passed
	“JointSealR® Foam Joint Tape”	See CCMC 14003-R	Passed
	“FlashSealR® Foam Flashing Tape”	See CCMC 14003-R	Passed

**Note to Table 4.1.3:**

- 1 The results of the testing were deemed a pass when reviewing the performance of the control specimen and considering the error and bias of the test procedure.

**Table 4.1.4 Wind Load Resistance for the Product**

XPS Panel	Attachment Schedule	Wind Load Limit (Q <sub>50</sub> )	Deflection Beyond Framing (Max.)
20-mm “FOAMULAR® CodeBord®”	Nails with 25-mm (1-in.) diameter cap washers, at 150 mm (6 in.) o.c., into wood studs at 400 mm (16 in.) o.c.	Q <sub>50</sub> ≤ 0.75 kPa	22 mm
25-mm “FOAMULAR® CodeBord®”	Nails with 25-mm (1-in.) diameter cap washers, at 150 mm (6 in.) o.c., into wood studs 600 mm (24 in.) o.c.	Q <sub>50</sub> ≤ 0.55 kPa	11 mm

## Report Holder

Owens Corning Canada Inc.  
3450 McNicoll Avenue  
Scarborough, ON M1V 1Z5

**Telephone:** 800-840-8725

**Fax:** 416-412-7090

**Web:** [www.owenscorning.ca](http://www.owenscorning.ca)

## Plant(s)

Grande-Île (Valleyfield), QC

## Disclaimer

*This Report is issued by the Canadian Construction Materials Centre, a program of NRC Construction at the National Research Council of Canada. The Report must be read in the context of the entire CCMC Registry of Product Evaluations, including, without limitation, the introduction therein which sets out important information concerning the interpretation and use of CCMC Evaluation Reports.*

*Readers must confirm that the Report is current and has not been withdrawn or superseded by a later issue. Please refer to [http://www.nrc-cnrc.gc.ca/eng/solutions/advisory/ccmc\\_index.html](http://www.nrc-cnrc.gc.ca/eng/solutions/advisory/ccmc_index.html), or contact the Canadian Construction Materials Centre, NRC Construction, National Research Council of Canada, 1200 Montreal Road, Ottawa, Ontario, K1A 0R6. Telephone (613) 993-6189. Fax (613) 952-0268.*

*NRC has evaluated the material, product, system or service described herein only for those characteristics stated herein. The information and opinions in this Report are directed to those who have the appropriate degree of experience to use and apply its contents. This Report is provided without representation, warranty, or guarantee of any kind, expressed, or implied, and the National Research Council of Canada (NRC) provides no endorsement for any evaluated material, product, system or service described herein. NRC accepts no responsibility whatsoever arising in any way from any and all use and reliance on the information contained in this Report. NRC is not undertaking to render professional or other services on behalf of any person or entity nor to perform any duty owed by any person or entity to another person or entity.*

**Date modified:**  
2016-01-15

## Appendix A – Additional Information

Figures 1 to 5 outline the specimens tested representing typical construction details to be reproduced in the field by OC-trained installers as part of the installation quality control of the “FOAMULAR® CodeBord® Air Barrier System (CABS).” See Owens Corning’s installation manuals entitled “FOAMULAR® CodeBord® Air Barrier System” publication no/ 300494, dated 2011 and “FOAMULAR® CodeBord® Air Barrier System Illustrative Guide” publication no/500668, dated June 2014, for more complete details.

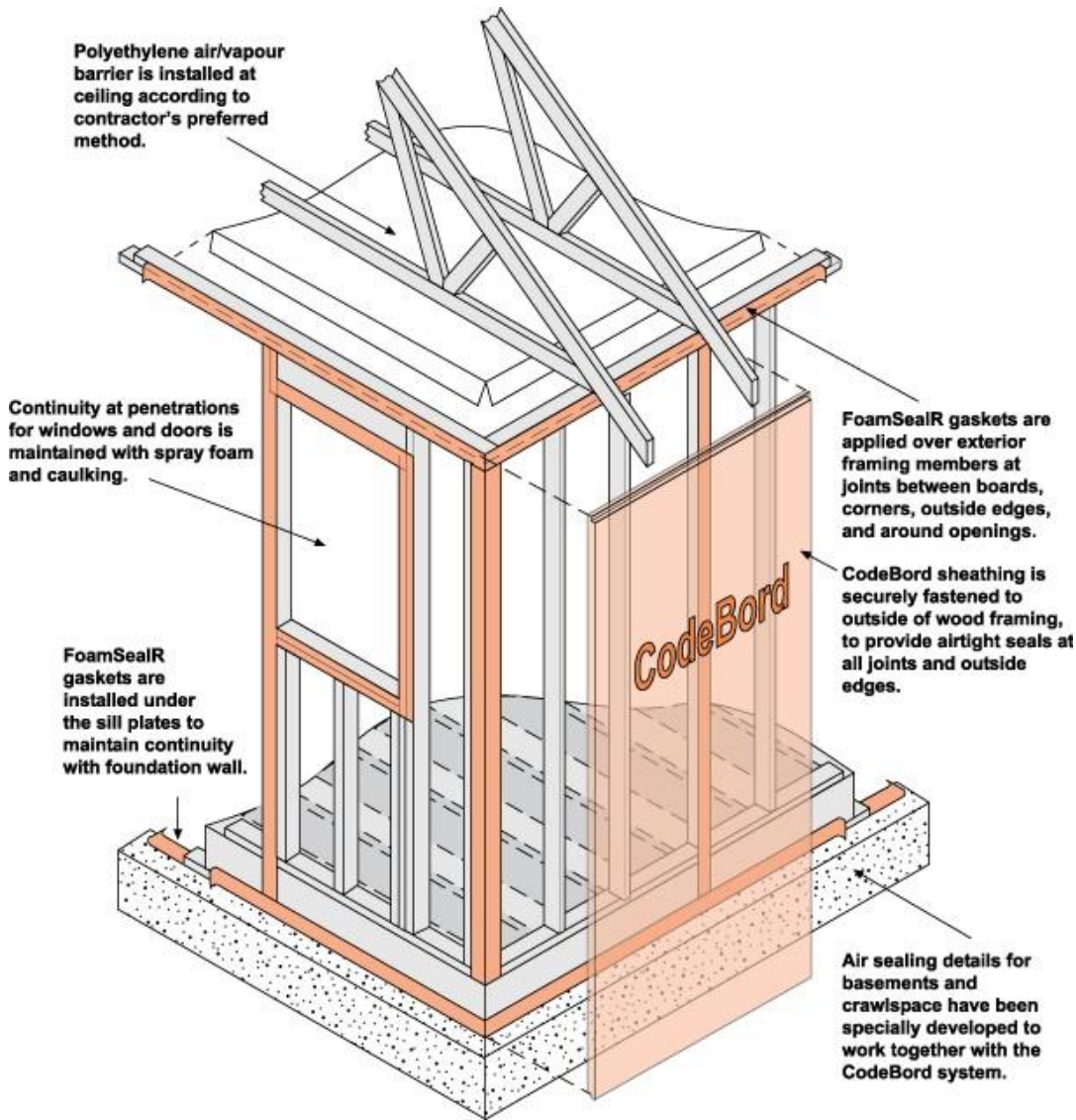
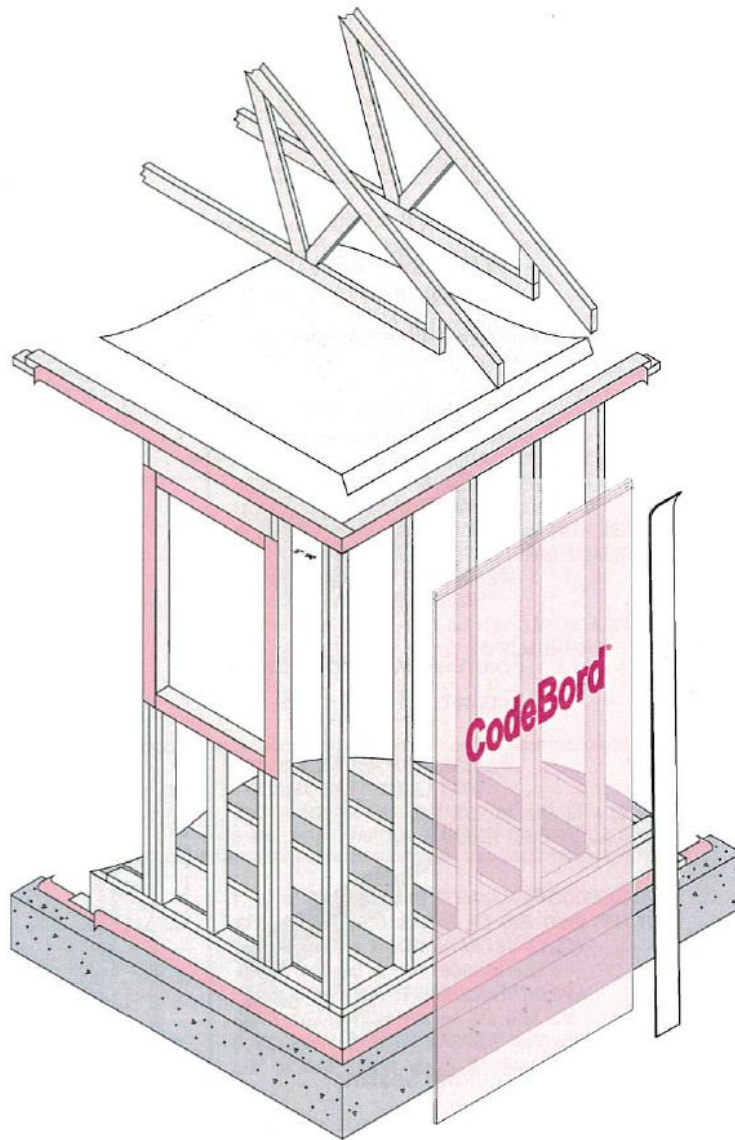
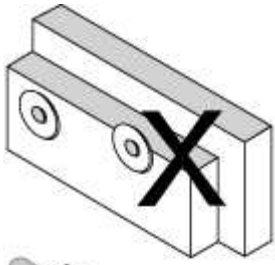

Figure 1. “FOAMULAR® CodeBord® Air Barrier System (CABS)” – original CABS

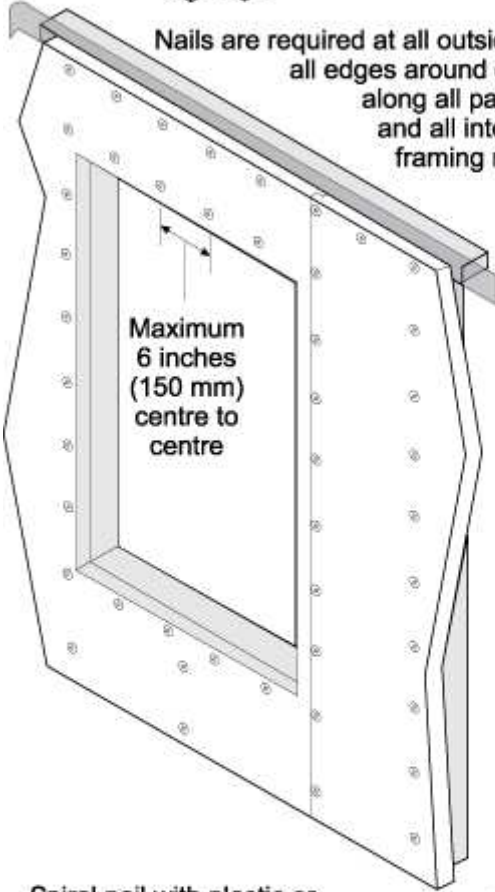



**Figure 2. Hybrid “FOAMULAR® CodeBord® Air Barrier System (CABS)” with exterior seam and flashing tape**



**NEVER** set nails so that washers overlap the edges of the sheathing. This prevents proper joining of boards.



Nails are required at all outside edges, all edges around openings, along all panel joints, and all intermediate framing members.

Maximum 6 inches (150 mm) centre to centre

Spiral nail with plastic or metal washers are the only approved means of fastening the sheathing.

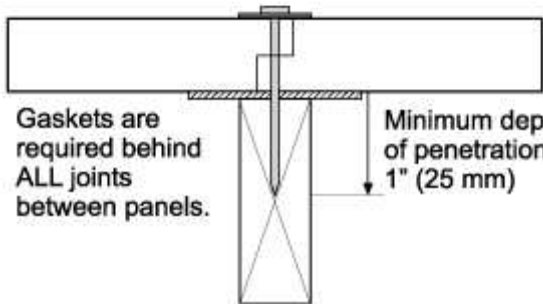

Gaskets are required behind ALL joints between panels.

Minimum depth of penetration 1" (25 mm)

Figure 3. "FOAMULAR® CodeBord® Air Barrier System (CABS)" sealing with gasket at joints (original CABS) and fastening details (or hybrid CABS, the gasket is replaced by a proprietary sheathing tape over the panel joint)



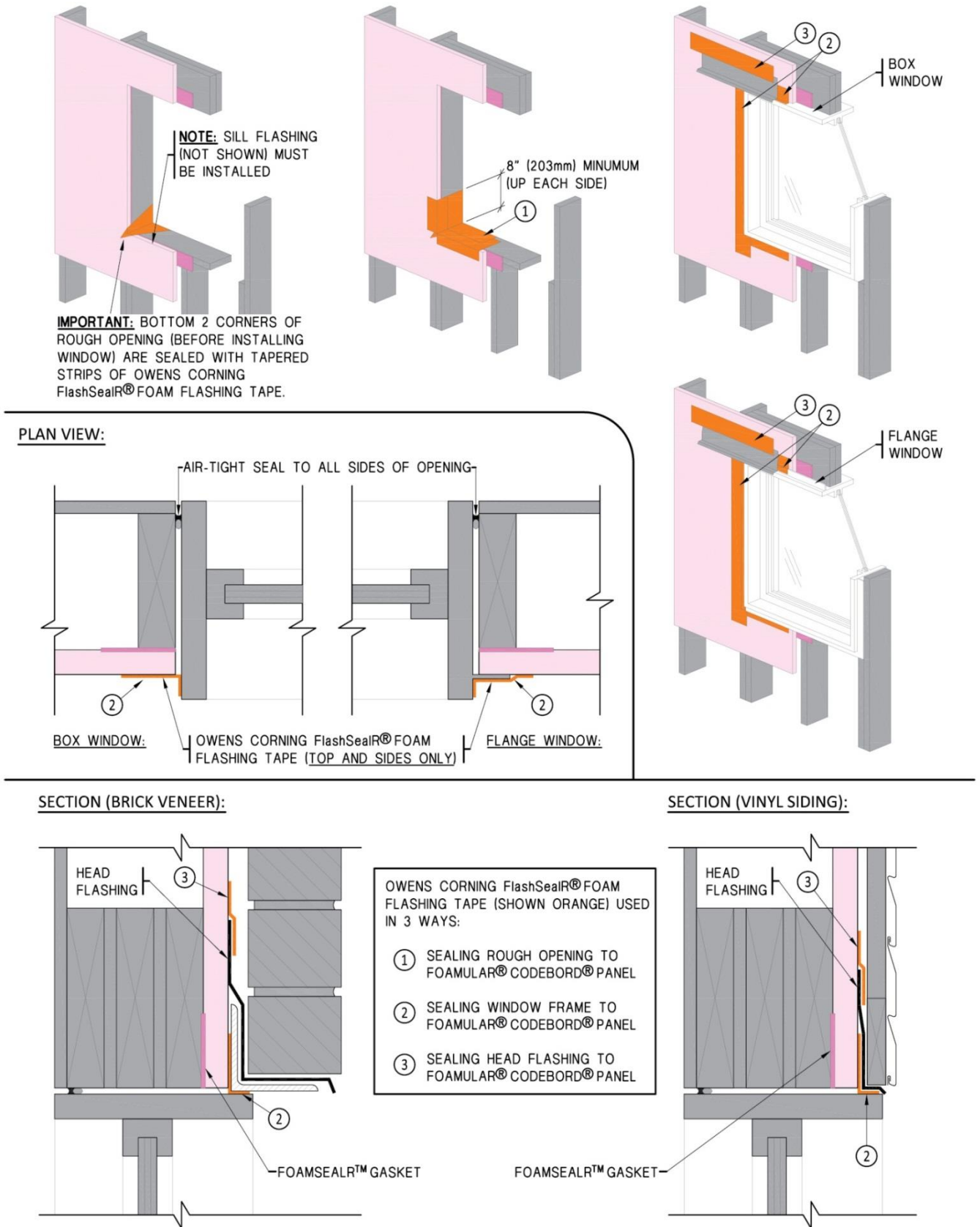
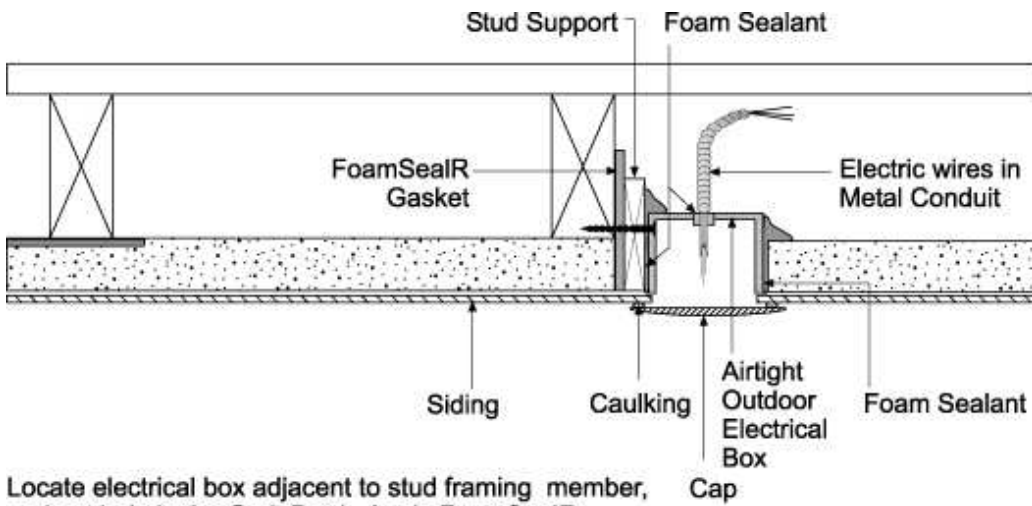

Figure 4. Sealing details around box and flanged windows (see manufacturer's literature for other sealing options)



Locate electrical box adjacent to stud framing member, and cut hole in the CodeBord. Apply FoamSealR gasket to stud and attach stud support for electrical box. Screw the airtight outdoor electrical box to stud support. Seal around the electrical box with PinkSeal foam sealant. Seal the opening for the electrical wires. Caulk the box cap to the siding.

Figure 5. Sealing of exterior electrical boxes to maintain plane of airtightness