

## Senerflex Platinum CI

Typical details for an exterior cladding system featuring Neopor® rigid insulation board

### Notes:

- All terminations must be fully encapsulated with mesh reinforced base coat.
- Ensure a means for drainage is provided at system termination at roof.
- Terminate system a minimum of 50 mm (2") above sloped roof.
- Ensure step flashing is a minimum of 50 mm (2") behind system.
- Kick-out flashing: sealed or soldered seams, recommended minimum 100 mm (4") in height, extend minimum 50 mm (2") from system and angled to direct water into gutter / away from wall surface.
- Do not apply finish to areas that will receive sealant.

### TYPICAL KICK-OUT FLASHING

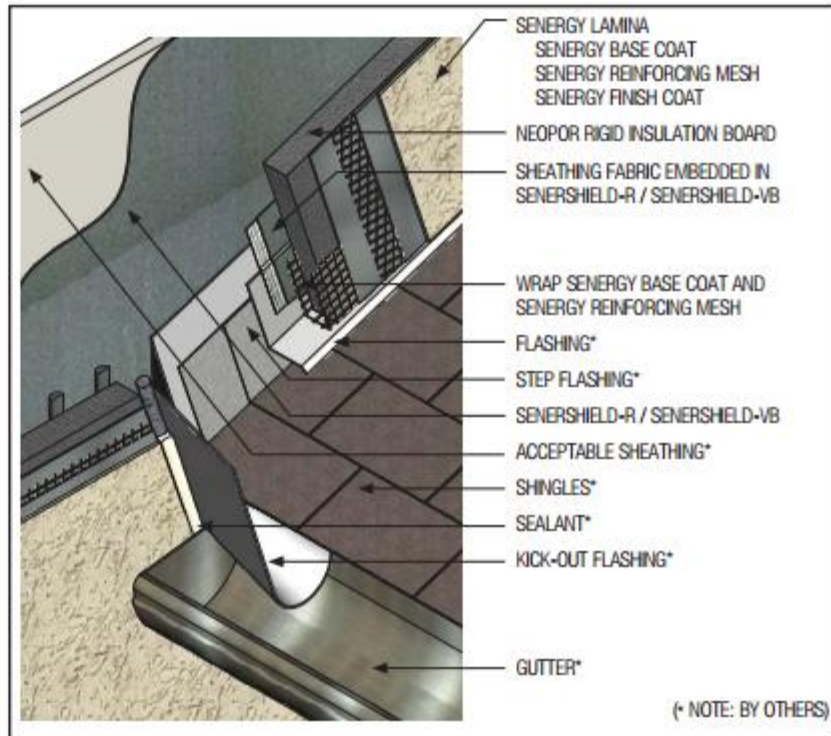

# Senerflex® Channeled Adhesive Design

## Water Drainage Class PB Exterior Insulation and Finish System

### Notes:

- Verify all materials are installed in accordance with current installation instructions.
- All terminations must be fully encapsulated with mesh reinforced base coat.
- Ensure a means for drainage is provided at system termination at roof.
- Terminate system a minimum of 50 mm (2") above roof.
- Ensure step flashing is a minimum of 50 mm (2") behind system.
- Kick-out flashing shall be a minimum of 102 mm (4") in height.
- Do not apply finish to areas that will receive sealant.

### TYPICAL KICK-OUT FLASHING

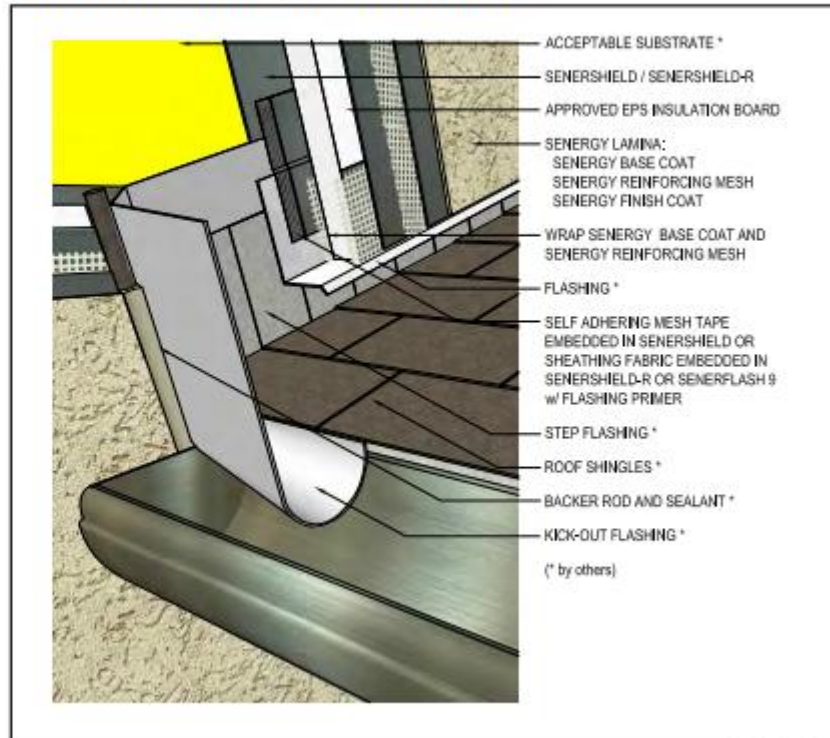

CA-27 0912

# Sentry Stucco Wall System

## Cement Plaster Stucco

### Notes:

- Verify all materials are installed in accordance with installation instructions and applicable code.
- Terminate Stucco Wall System a minimum of 50 mm (2") above roof.
- Ensure step flashing is a minimum 50 mm (2") behind Sentry Stucco Wall System.
- Kick-out flashing a minimum 100 mm (4") in height.
- Kick-out flashing shall be angled a minimum 100° with seams sealed or soldered.
- Ensure a means for drainage is provided at system termination at roof.

### TYPICAL KICK-OUT FLASHING

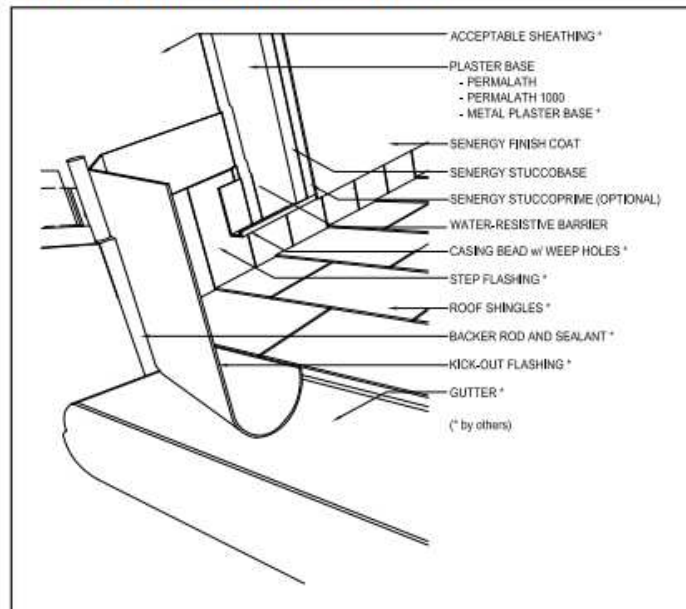

SSWS-19 0310

# Senerflex® Classic PB Wall System

Class PB Exterior Insulation and Finish System providing a primary moisture barrier and optional secondary air/weather barrier

## TYPICAL KICK-OUT FLASHING

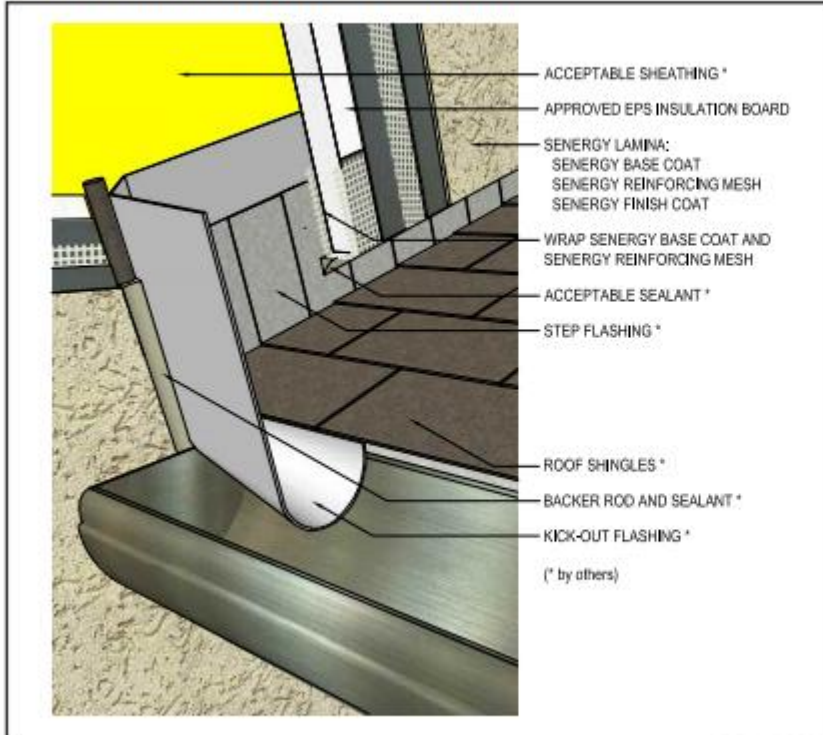

### Notes:

- Verify all materials are installed in accordance with installation instructions.
- All terminations must be fully encapsulated with mesh reinforced base coat.
- Do not apply finish to areas that will receive sealant.
- Terminate system a minimum of 51 mm (2") above roof.
- Ensure step flashing is a minimum of 51 mm (2") behind system.
- Kick-out flashing shall be a minimum of 102 mm (4") in height, angled at 100° minimum; seams must be soldered or sealed with appropriate sealant.

PB-21 0310