

Gold Bond® BRAND

09 29 00/NGC

3/4" Ultra-Shield FS® Gypsum Board



National 
Gypsum®

Gold Bond® BRAND

3/4" Ultra-Shield FS® Gypsum Board

Does Double Duty For Single-Layer Steel Stud And Cavity Shaftwall Systems



Provides more fire resistance.

Specially formulated core has added fire-resistive qualities and is UL Classified for fire resistance, surface burning characteristics and noncombustibility.



Speeds up installation.

Scores and snaps easily and cuts quickly, permitting painting or other decoration and the installation of metal or wood trim almost immediately.



Reduces costs.

Lessen labor and material costs by using fewer layers (up to 10%).

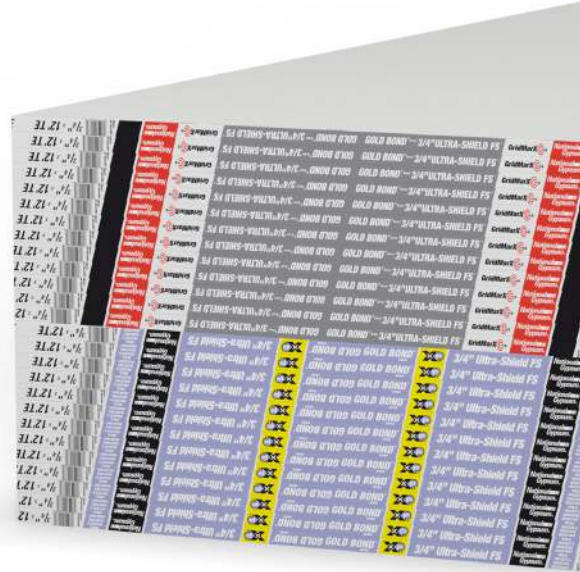

Streamline Your Project With 3/4" Ultra-Shield FS®

You can save time, labor and material costs with Gold Bond® BRAND 3/4" Ultra-Shield FS® Gypsum Board. This efficient, UL-Classified gypsum board does double duty for single-layer steel stud and cavity shaftwall systems. The increased board thickness provides more resistance to fire and reduced sound transmission versus a single layer of 5/8" Type X Gypsum Board.

Specify 3/4" Ultra-Shield FS® Gypsum Board for common two-hour rated wall partitions and cavity shaftwall systems for shaftwalls that enclose elevators, stairways and other vertical chases.

Fire-Rated Assembly Drawings

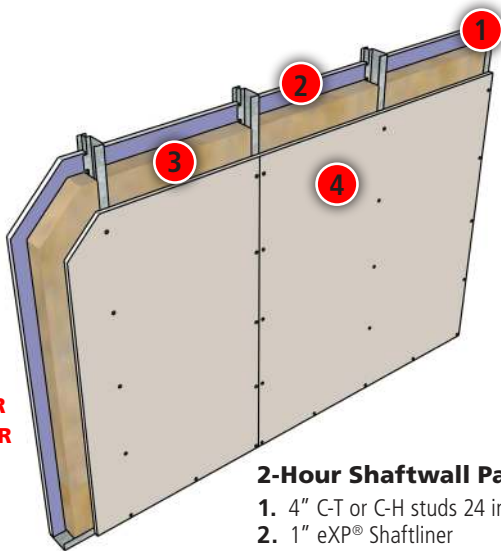

W441-2HR
W419-2HR

2-Hour Shaftwall Partition

1. 4" C-T or C-H studs 24 in. o.c.
2. 1" eXP® Shaftliner
3. 3" mineral wool insulation
4. 3/4" Ultra-Shield FS® Gypsum Board

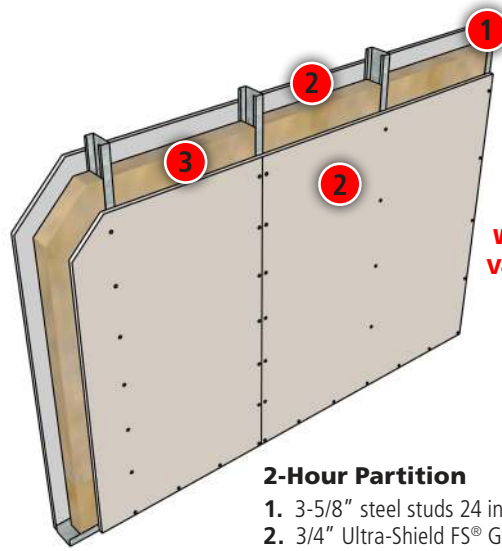

W432-2HR
W438-2HR

2-Hour Partition

1. 3-5/8" steel studs 24 in. o.c.
2. 3/4" Ultra-Shield FS® Gypsum Board
3. 3" mineral wool insulation

Technical Overview

Physical Properties	3/4" Ultra-Shield FS [®]
Thickness ¹ , Nominal	3/4" (19.05 mm)
Width ¹ , Nominal	4' (1,219 mm)
Length ^{1,4} , Standard	8' - 12' (2,438 - 3,658 mm)
Weight, Nominal	2.85 lbs./sq. ft. (13.91 kg/m ²)
Edges ¹	Tapered
Flexural Strength, perpendicular ¹	≥ 167 lbf. (743 N)
Flexural Strength, parallel ¹	≥ 56 lbf. (56 N)
Humidified Deflection ¹	≤ 5/8" (16 mm)
Nail Pull Resistance ¹	≥ 97 lbf. (432 N)
Hardness core ¹ , edges and ends	≥ 11 lbf. (49 N)
Bending Radius	N/A
Thermal Resistance ⁵	R = .64
Product Standard Compliance	ASTM C 1396

Fire-Resistance Characteristics	
Core Type	Type X
UL Type Designation	Ultra-Shield
Combustibility ²	Noncombustible Core
Surface Burning Characteristics ³	Class A
Flame Spread	15
Smoke Development	0

Applicable Standards and References
ASTM C473 Standard Test Methods for Physical Testing of Gypsum Panel Products
ASTM C518 Standard Test Method for Steady-State Thermal Transmission Properties by Means of the Heat Flow Meter Apparatus
ASTM C840 Standard Specification for Application and Finishing of Gypsum Board
ASTM C1396 Standard Specification for Gypsum Board
ASTM E84 Standard Test Method for Surface Burning Characteristics of Building Materials
ASTM E136 Standard Test Method for Behavior of Method for Behavior of Materials in a Vertical Tube Furnace at 7500C
Gypsum Association, GA-214, <i>Recommended Levels of Finish for Gypsum Board, Glass Mat and Fiber-Reinforced Gypsum Panels</i>
Gypsum Association, GA-216, <i>Application and Finishing of Gypsum Panel Products</i>
Gypsum Association, GA-238, <i>Guidelines for Prevention of Mold Growth on Gypsum Board</i>
National Gypsum Company, <i>NGC Construction Guide</i>

¹Specified minimum values per ASTM C1396, tested in accordance with ASTM C473.

²Tested in accordance with ASTM E136.

³Tested in accordance with ASTM E84.

⁴Special lengths may be available. Contact your local sales representative for more information.

⁵Tested in accordance with ASTM C518.

About Gold Bond[®] BRAND 3/4" Ultra-Shield[®] FS Gypsum Board

3/4" Ultra-Shield FS[®] Gypsum Board has a fire-resistant gypsum core FS enclosed in a heavy, natural-finish, 100% recycled paper on the face and back. The Type X Fire-Shield core contains various aggregates, such as fiberglass, to enhance its fire-resistive qualities. 3/4" Ultra-Shield is a component in laboratory tested fire rated assemblies.

Reinforce the joints between 3/4" Ultra-Shield with ProForm[®] BRAND Joint Tape and conceal with ProForm[®] BRAND Ready Mix or ProForm[®] BRAND Quick Set[™] Setting Joint Compounds.

It is also available with added mold and moisture resistance (Gold Bond[®] BRAND 3/4" Ultra-Shield FS[®] XP[®] Gypsum Board).

LIMITED WARRANTY AND REMEDIES

Products manufactured and sold by National Gypsum Company are warranted by National Gypsum Company to its customers to be free from defects in materials and workmanship at the time of shipment. THIS EXPRESS WARRANTY IS THE ONLY WARRANTY APPLICABLE TO SUCH PRODUCTS, AND IS IN LIEU OF AND EXCLUDES ALL OTHER EXPRESS ORAL OR WRITTEN WARRANTIES AND ALL IMPLIED WARRANTIES, INCLUDING BUT NOT LIMITED TO THE IMPLIED WARRANTIES OF MERCHANTABILITY AND FITNESS FOR A PARTICULAR PURPOSE.

National Gypsum Company will not be liable for any incidental, indirect or consequential losses, damages or expenses. The customer's exclusive remedy for any type of claim or action for defective products will be limited to the replacement of the products (in the form originally shipped) or, at National Gypsum's option, to a payment or credit not greater than the original purchase price of the products.

Mold And Mildew Resistance

Gold Bond® BRAND XP® Gypsum Board products with Sporgard™ were designed to provide extra protection against mold and mildew compared to standard wallboard products. When tested by an independent laboratory, XP Gypsum Board products with Sporgard received the highest possible ratings on ASTM G21 and D3273.

National Gypsum Company will not be liable for products claimed to be defective where the defect resulted from causes not within National Gypsum's control, or which arose or occurred after shipment, including but not limited to accidents, misuse, mis-handling, improper installation, contamination or adulteration by other materials or goods, or abnormal conditions of temperature, moisture, dirt or corrosive matter.

Any claim that products sold by National Gypsum Company were defective or otherwise did not conform to the contract of sale is waived unless the customer submits it in writing to National Gypsum within thirty (30) days from the date the customer discovered or should have discovered the defect or non-conformance. No legal action or proceeding complaining of goods sold by National Gypsum may be brought by the customer more than one year after the date the customer discovered or should have discovered the defect or problem of which it complains.

No material can be considered "mold proof," nor is it certain that any material will resist mold or mildew indefinitely. When used in conjunction with good design, handling and construction practices, XP Gypsum Board products can provide increased mold resistance versus standard wallboard products. As with any building material, avoiding water exposure during handling, storage and installation, and after installation is complete, is the best way to avoid the formation of mold or mildew.

CUSTOMER SERVICE SALES AREAS

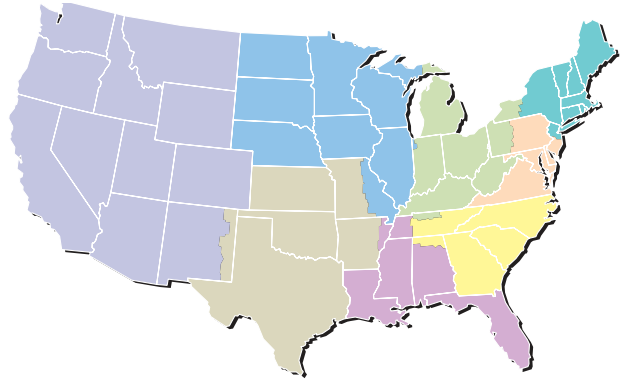

Atlantic Area

Phone: (800) 237-9167
Fax: (877) 252-0430

Central Area

Phone: (800) 252-1065
Fax: (866) 232-0440

Gulf Area

Phone: (800) 343-4893
Fax: (866) 482-8940

Midwest Area

Phone: (800) 323-1447
Fax: (866) 692-8590

Northeast Area

Phone: (800) 253-3161
Fax: (866) 632-1480

Southeast Area

Phone: (800) 548-9394
Fax: (866) 732-1990

Southwest Area

Phone: (800) 548-9396
Fax: (866) 792-7520

Western Area

Phone: (800) 824-4227
Fax: (800) 438-6266

National Accounts

Phone: (800) 440-1230
Fax: (866) 622-3590

Manufactured Housing

Phone: (800) 455-3185
Fax: (800) 639-1714



PRODUCT
CERTIFIED FOR
LOW CHEMICAL
EMISSIONS:
UL.COM/IGG
UL 2818

Corporate Headquarters

National Gypsum Company
2001 Rexford Road
Charlotte, NC 28211
Phone: (704) 365-7300
Web: nationalgypsum.com

Technical Information

Phone: (800) NATIONAL
(800) 628-4662
Fax: (800) FAX-NGC1
(800) 329-6421

