



**TECHSHIELD®**  
RADIANT BARRIER

## LP® TechShield® Radiant Barrier Sheathing

# Roof sheathing installation for metal roofing.

LP® TechShield® works fine with a metal roof as long as you follow the installation instructions, making sure to leave a 3/4" air space for the foil surface of the LP TechShield radiant barrier.

Figure 1

### WOOD TRUSS ROOF SYSTEM

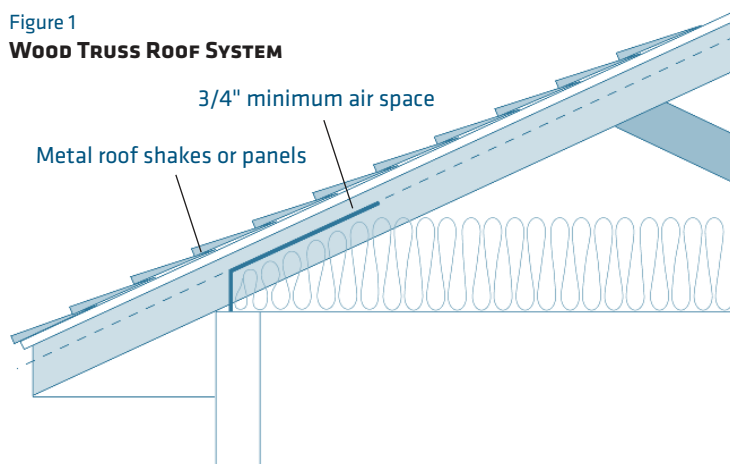
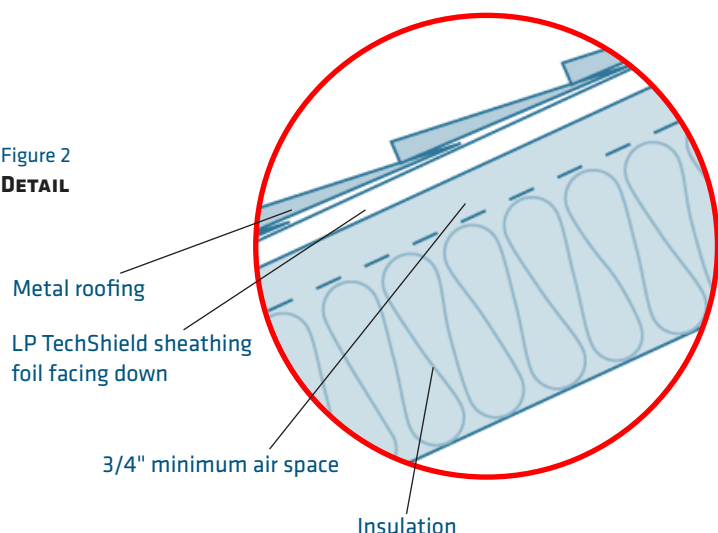

Figure 2

### DETAIL



These steps are necessary.

1. Always check for uniform rafter alignment. Be sure to use LP TechShield with the proper thickness for the required on-center rafter spacing.
2. Provide adequate roof ventilation according to building code in your area.
3. Panel spacing on ends and edges should be 1/8".
4. Place LP TechShield radiant barrier sheathing panels with the foil side facing down on the roof (toward the attic air space). 3/4" minimum air space required. (See Figures 1 & 2)
5. Fasten the panels a minimum of 6" on center at supported panel ends and edges and 12" on center at intermediate supports. 8d nails are recommended.
6. Protect LP TechShield panels from moisture prior to and during installation.
7. Use shingle underlayment (or 30# roofing felt) to cover roof as soon as possible to protect panels from exposure to adverse weather conditions.
8. Allow sheathing to adjust to atmospheric conditions before installation of metal roofing.
9. Install all panels with APA and LP TechShield sheathing trademarks DOWN.
10. Follow the roofing manufacturer's application instructions.

For a copy of the warranty or for installation and technical support visit: [www.lpcorp.com/techshield](http://www.lpcorp.com/techshield)  
Phone: 888.820.0325  
Email: [customer.support@lpcorp.com](mailto:customer.support@lpcorp.com)



**Cal. Prop 65 Warning: Use of this product may result in exposure to wood dust, known to the State of California to cause cancer.**

