

DECO-TOUCH WALL CONTROL INSTALLATION AND OWNER GUIDE

THIS WALL CONTROL MAY BE USED WITH THE FOLLOWING VENTILATION UNITS:

VENMAR UNITS

- AVS Solo
- AVS Duo
- COMPACT
- HRV AND ERV EKO 1.5
- ERV CONSTRUCTO 2.0ES
- AVS KUBIX HRV PLUS AND ERV
- HE
- NOVOFIT
- HRV CONSTRUCTO 1.5V*, 1.5ES AND 2.0ES
- CONSTRUCTO 1.0*

VÄNÉE UNITS

- GOLD SERIES
- VIGÖR HRV PLUS
- VIGÖR ERV
- HRV AND ERV 90H-V ECM
- 90H-V*
- HE*
- Novo+
- 60H*
- 100H
- 200H

*CONSTRUCTO 1.0 AND VÄNÉE 60H BUILT IN AUGUST 2008 AND LATER, VÄNÉE HE BUILT IN JULY 2006 AND LATER AND CONSTRUCTO 1.5V AND VÄNÉE 90H-V BUILT IN NOVEMBER 2012 AND LATER. THE DATE CODE ON THE UNIT IS PART OF ITS 13-DIGIT SERIAL NUMBER. FOR EXAMPLE, THE SERIAL NUMBER XXXX0708XXXX, WHERE 07 IS THE YEAR AND 08 THE MONTH (AUGUST), THE DATE CODE IS ALWAYS THE FIFTH, SIXTH, SEVENTH AND EIGHTH DIGITS.

WALL CONTROL INSTALLATION

⚠ WARNING

IT IS RECOMMENDED TO WEAR SAFETY GLASSES AND GLOVES WHILE PERFORMING THESE INSTRUCTIONS. ALWAYS DISCONNECT THE UNIT BEFORE MAKING ANY CONNECTIONS. FAILURE TO DISCONNECT POWER COULD RESULT IN ELECTRIC SHOCK OR DAMAGE TO THE WALL CONTROL OR ELECTRONIC MODULE INSIDE THE UNIT.

CAUTION

FAILURE TO COMPLY WITH THE FOLLOWING CAN CAUSE ERRATIC OPERATION OF THE UNIT AND/OR THE WALL CONTROL:

- NEVER INSTALL MORE THAN ONE MAIN WALL CONTROL PER VENTILATION UNIT;
- KEEP CONTROL LOW VOLTAGE WIRING AT LEAST 1 FOOT (305 MM) AWAY FROM MOTORS, LIGHTING BALLAST, LIGHT DIMMING CIRCUIT AND POWER DISTRIBUTION PANEL. Do NOT ROUTE CONTROL WIRING ALONGSIDE HOUSE POWER WIRING;
- ENSURE THE WIRES ARE SECURELY CONNECTED.

1 UNPLUG THE VENTILATION UNIT FROM POWER SOURCE.

2 CUT A 2 7/8" x 1 3/8" HOLE IN A WALL, AT A CONVENIENT LOCATION FOR THE WALL CONTROL. ROUTE THE CABLE FROM THE UNIT TO THIS HOLE.

NOTE: DIMENSIONS SHOWN ARE FOR AN INSTALLATION WITHOUT WALL BOX.

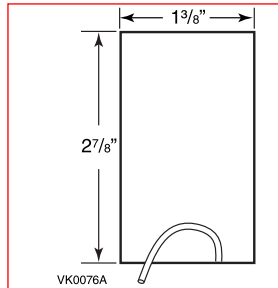

3 TEMPORARILY PLACE THE SWITCH OVER THE HOLE AND MARK BOTH MOUNTING SCREW HOLE POSITIONS.

4 REMOVE THE SWITCH, DRILL BOTH SCREW HOLES (3/16" Ø) IN WALL AND INSERT WALL ANCHORS (INCLUDED).

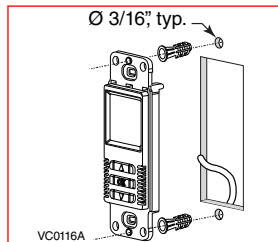

5 STRIP THE END OF THE CABLE TO ACCESS THE 4 WIRES. STRIP THE END OF EACH WIRE. USING A SMALL BLADE SCREWDRIVER, CONNECT EACH WIRE TO ITS CORRESPONDING TERMINAL, ON THE BACK OF THE WALL CONTROL: YELLOW WIRE TO "Y"; RED WIRE TO "R"; GREEN WIRE TO "G" AND BLACK WIRE TO "B".

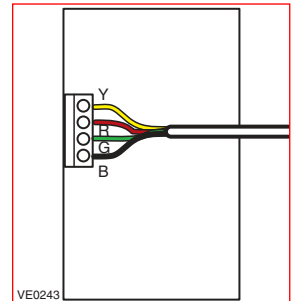

6 MOUNT THE WALL CONTROL TO THE WALL. PLUG THE VENTILATION UNIT AND TEST THE WALL CONTROL OPERATION.

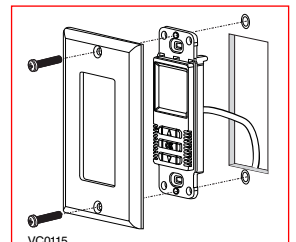

WALL CONTROL USE

BACKLIGHT

IF THE BACKLIGHT IS NOT ILLUMINATED, THE FIRST BUTTON PRESSED (NO MATTER WHICH BUTTON) SHALL TURN ON THE BACKLIGHT. THE BACKLIGHT REMAINS ILLUMINATED FOR 10 SECONDS AFTER THE LAST BUTTON PRESSED.

OPERATING MODES

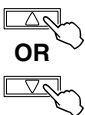

TO CHANGE THE OPERATION MODES OF THE VENTILATION UNIT, PRESS THE UP OR DOWN ARROW BUTTON. OPERATING MODE LABEL WILL THEN SCROLL UP OR DOWN ON LCD SCREEN.

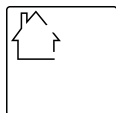

OFF

PUT THE UNIT ON STAND-BY MODE, SO IT WILL ONLY RESPOND TO OVERRIDE WALL CONTROLS (IF PRESENT). ON LCD SCREEN, ONLY THE HOUSE IS VISIBLE SHOWING THE CONTROL IS POWERED ON. THIS IS THE FACTORY DEFAULT MODE.



RECIRC

AIR IS RECIRCULATED INSIDE THE HOUSE AT HIGH SPEED.
NOTE: THIS MODE IS NOT AVAILABLE WITH THE FOLLOWING UNITS:
HRV CONSTRUCTO 1.5V, 1.5ES, 2.0ES,
ERV CONSTRUCTO 2.0ES AND VÄNÉE 100H, 200H, 90H-V.

OPERATING MODES (CONT'D)

20 MIN/H

THE VENTILATION UNIT EXCHANGES AIR INTERMITTENTLY ON A ONE HOUR CYCLE AS FOLLOWS: OFF FOR 40 MIN. (OR RECIRCULATION* ON HIGH SPEED FOR 40 MIN., SEE NEXT SECTION ON BACK PAGE) AND THEN EXCHANGE AIR DURING 20 MIN. ON LOW SPEED. REPEAT CYCLE AFTER THE 20 MIN. OF AIR EXCHANGE.

*EXCEPT FOR HRV CONSTRUCTO 1.5V, 1.5ES, 2.0ES, ERV CONSTRUCTO 2.0ES AND VÄNÉE 100H, 200H AND 90H-V UNITS.



MIN

AIR IS EXCHANGED WITH THE OUTSIDE ON LOW SPEED.



MAX

AIR IS EXCHANGED WITH THE OUTSIDE ON HIGH SPEED.

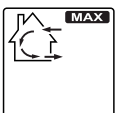

WALL CONTROL USE (CONT'D)

HOW TO SET THE RELATIVE HUMIDITY (RH) LEVEL AND CHOOSE BETWEEN OFF IN STAND BY OR RECIRCULATION IN STAND BY*

SETTING THE RELATIVE HUMIDITY LEVEL ALLOWS TO SELECT THE MAXIMUM DESIRED INDOOR HUMIDITY LEVEL (IN PERCENTAGE). THIS VALUE WILL BE USED TO START THE DEHUMIDISTAT OVERRIDE (AIR EXCHANGE ON HIGH SPEED).

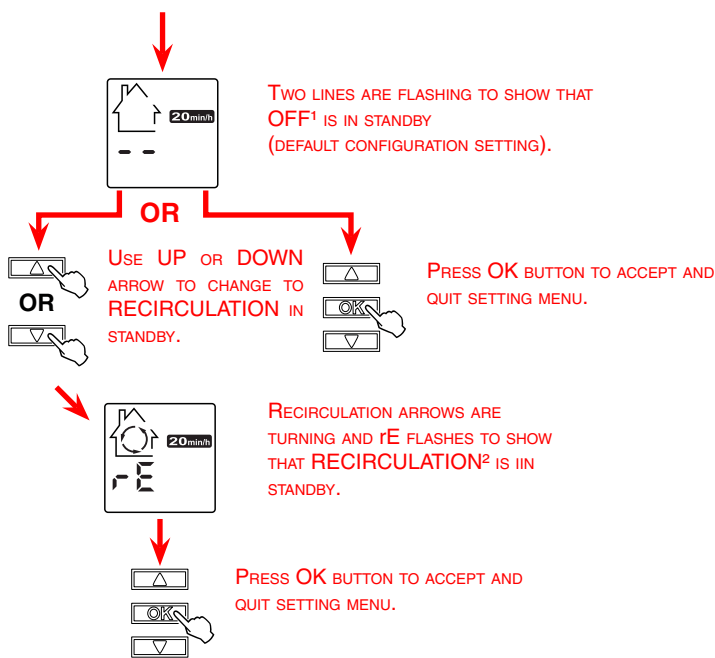
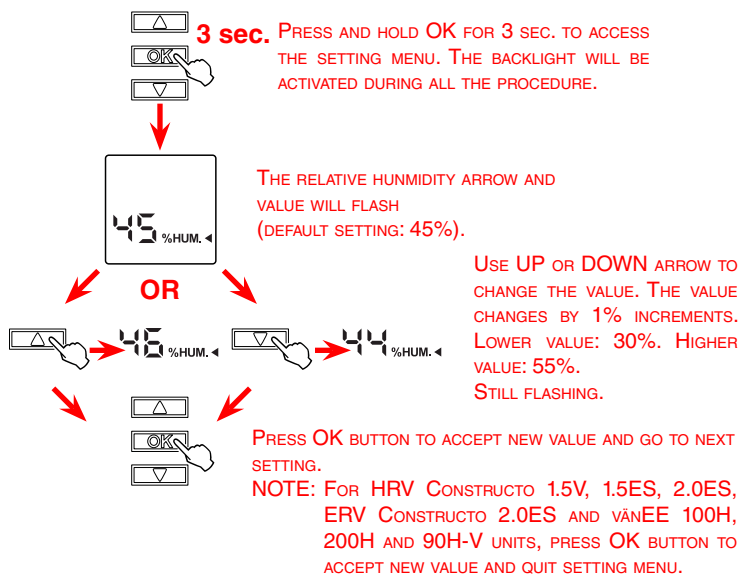

¹OFF IN STANDBY*: ON 20 MIN/H MODE, THE VENTILATION UNIT IS OFF DURING 40 MINUTES AND EXCHANGES AIR WITH THE OUTSIDE ON LOW SPEED DURING THE REMAINING 20 MINUTES OF THE HOUR; THIS IS THE DEFAULT VALUE.

²RECIRCULATION IN STANDBY*: ON 20 MIN/H MODE, THE VENTILATION UNIT RECIRCULATES THE INSIDE AIR FOR 40 MINUTES ON HIGH SPEED AND EXCHANGES AIR WITH THE OUTSIDE ON LOW SPEED DURING THE REMAINING 20 MINUTES OF THE HOUR.

*OFF IN STANDBY AND RECIRCULATION IN STANDBY ARE NOT AVAILABLE FOR HRV CONSTRUCTO 1.5V, 1.5ES, 2.0ES, ERV CONSTRUCTO 2.0ES AND VÄNEE 100H, 200H AND 90H-V UNITS.

DEHUMIDISTAT OVERRIDE SELECTION

IN THE OPERATING MODES MIN, MAX, 20 MIN/H AND RECIRC (IF AVAILABLE), THE USER CAN SELECT A DEHUMIDISTAT OVERRIDE SO THAT IF THE RELATIVE HUMIDITY (RH) IN THE HOUSE EXCEEDS THE RH SETTING PREVIOUSLY STORED, THE VENTILATION UNIT WILL EXCHANGE IN HIGH SPEED UNTIL THE TARGET INDOOR RH SETTING IS REACHED.

AN AIR EXCHANGER IS NOT A DEHUMIDIFIER, BUT IT CAN CHANGE THE INDOOR RELATIVE HUMIDITY BY BRINGING IN DRIER OR MORE HUMID AIR FROM OUTSIDE DURING NON HEATING SEASON. THE DEHUMIDISTAT OVERRIDE FUNCTION IS USEFUL TO REDUCE INDOOR RH WHEN THE OUTDOOR AIR IS COOL AND DRY DURING THE HEATING SEASON. SELECT A TARGET RH BETWEEN 30% AND 55% ACCORDING TO YOUR COMFORT. WHEN OUTDOOR RELATIVE HUMIDITY IS HIGH (E.G. IN SUMMER), TURN OFF THE OVERRIDE BY PRESSING OK UNTIL THE RH DISPLAY DISAPPEARS.



WHEN THE DEHUMIDISTAT OVERRIDE IS ACTIVATED, THE AUTO INDICATOR WILL APPEAR ON LCD SCREEN TO SHOW THAT THE ACTUAL MODE IS BEING OVERRIDDEN. ALSO, THE RELATIVE HUMIDITY APPEARS (IF IT WAS NOT SHOWN, SEE EXAMPLE BESIDE). ONCE THE TARGET HUMIDITY LEVEL IS REACHED, THE UNIT GOES BACK INTO ITS ORIGINAL OPERATING MODE AND AUTO DISAPPEARS FROM LCD SCREEN.

NOTE: IF THE ACTUAL MODE IS MAX, ONLY THE RELATIVE HUMIDITY LEVEL APPEARS ON SCREEN, AUTO LABEL WILL NOT APPEAR.

TO ENGAGE THE HUMIDITY OVERRIDE, PRESS OK. THE ACTUAL INDOOR RH AND THE %HUM LABEL APPEAR ON LCD SCREEN.

NOTE: IF THE ACTUAL RH IS LESS THAN 20%, THEN THE HUMIDITY INDICATOR WILL DISPLAY "LO"; AND IF THE ACTUAL RH IS GREATER THAN 80%, THEN THE HUMIDITY INDICATOR WILL DISPLAY "HI".

TO TURN OFF THE DEHUMIDISTAT OVERRIDE, PRESS OK AGAIN. THE RH AND %HUM DISPLAY WILL DISAPPEAR FROM LCD SCREEN.

POWER FAILURE

AFTER A POWER FAILURE, THE WALL CONTROL RETURNS TO ITS ORIGINAL OPERATION MODE. ALL SETTINGS ARE KEPT IN MEMORY.

ERROR CODES

IF THERE IS A PROBLEM WITH THE WALL CONTROL, AN ERROR CODE WILL APPEAR ON LCD SCREEN; IT COULD BE E1, E3 OR E7. IF THIS SITUATION OCCURS, UNPLUG THE VENTILATION UNIT FOR 20 SECONDS AND THEN REPLUG IT. IF THE ERROR CODE IS STILL PRESENT, PLEASE CALL YOUR INSTALLER.

MAINTENANCE INDICATOR

THE MAINTENANCE INDICATOR IS REPRESENTED BY AN M IN A ROUNDED TRIANGLE, AT THE TOP OF THE HOUSE (SEE AT RIGHT). IF THIS INDICATOR IS FLASHING, PERFORM THE REGULAR MAINTENANCE, AND IF IT IS NOT FLASHING, PERFORM THE ANNUAL MAINTENANCE (REFER TO THE VENTILATION UNIT USER GUIDE).

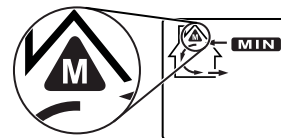

RESETTING MAINTENANCE INDICATOR: PRESS SIMULTANEOUSLY ON BOTH ARROW BUTTONS, MAINTENANCE INDICATOR WILL DISAPPEAR FROM LCD SCREEN.



WALL CONTROL RESET PROCEDURE

THE WALL CONTROL MUST BE RESET IF IT WAS PREVIOUSLY CONNECTED TO ANOTHER VENTILATION UNIT. TO PERFORM THE RESET:

- 1 PRESS SIMULTANEOUSLY ON DOWN ARROW AND OK BUTTONS FOR 8 SECONDS.
- 2 UNPLUG THE VENTILATION UNIT FOR 30 SECONDS.
- 3 PLUG BACK THE VENTILATION UNIT IN POWER SOURCE.

