

CUT A LENGTH OF ZIP SYSTEM TAPE (6-INCH TAPE IS RECOMMENDED) OR OTHER ADHESIVE BACKED FLASHING TAPE AND APPLY TO THE HEAD FLANGE ON THE WINDOW. ENSURE THE HEAD FLASHING OVERLAPS THE JAMB FLASHING.

CUT TWO PIECES OF ZIP SYSTEM TAPE (6-INCH ZIP TAPE IS RECOMMENDED) OR OTHER ADHESIVE BACKED FLASHING TAPE AND APPLY TO EACH OF THE WINDOW JAMB FLASHINGS. ENSURE THE JAMB FLASHINGS OVERLAP THE SILL FLASHING.

APPLY SEALANT AROUND INSIDE FACE OF WINDOW MOUNTING FLANGE. SEALANT MUST BE GAPPED AT THE BOTTOM FLANGE TO PERMIT DRAINAGE IF USED. INSTALL AND LEVEL WINDOW PER MANUFACTURERS INSTALLATION INSTRUCTIONS. VERIFY SEALANT COMPATIBILITY WITH WINDOW MANUFACTURER. WHEN USING ZIP SYSTEM TAPE, 100% SILICONE, BUTYL AND POLYURETHANE SEALANTS ARE ACCEPTABLE. DO NOT USE LATEX SEALANTS.

INSIDE SURFACE OF WINDOW FLANGE

APPLY A CONTINUOUS BEAD OF SEALANT AROUND THE TOP AND SIDES OF THE BACK SIDE (INTERIOR SURFACE) OF THE WINDOW MOUNTING FLANGE. SEALANT ALONG THE BOTTOM, IF USED, MUST BE GAPPED TO ALLOW DRAINAGE.

INSTALL SILL/PAN FLASHING THAT SATISFIES THE REQUIREMENTS OF ASTM E 2112-07. 6-INCH ZIP SYSTEM TAPE MAY BE USED AS PAN FLASHING IF INSTALLED IN ACCORDANCE WITH ASTM E 2112-07. OTHER ADHESIVE-BASED FLASHING MAY BE USED IF THEY SATISFY ICC-ES AC-148

DRAWING NOT TO SCALE

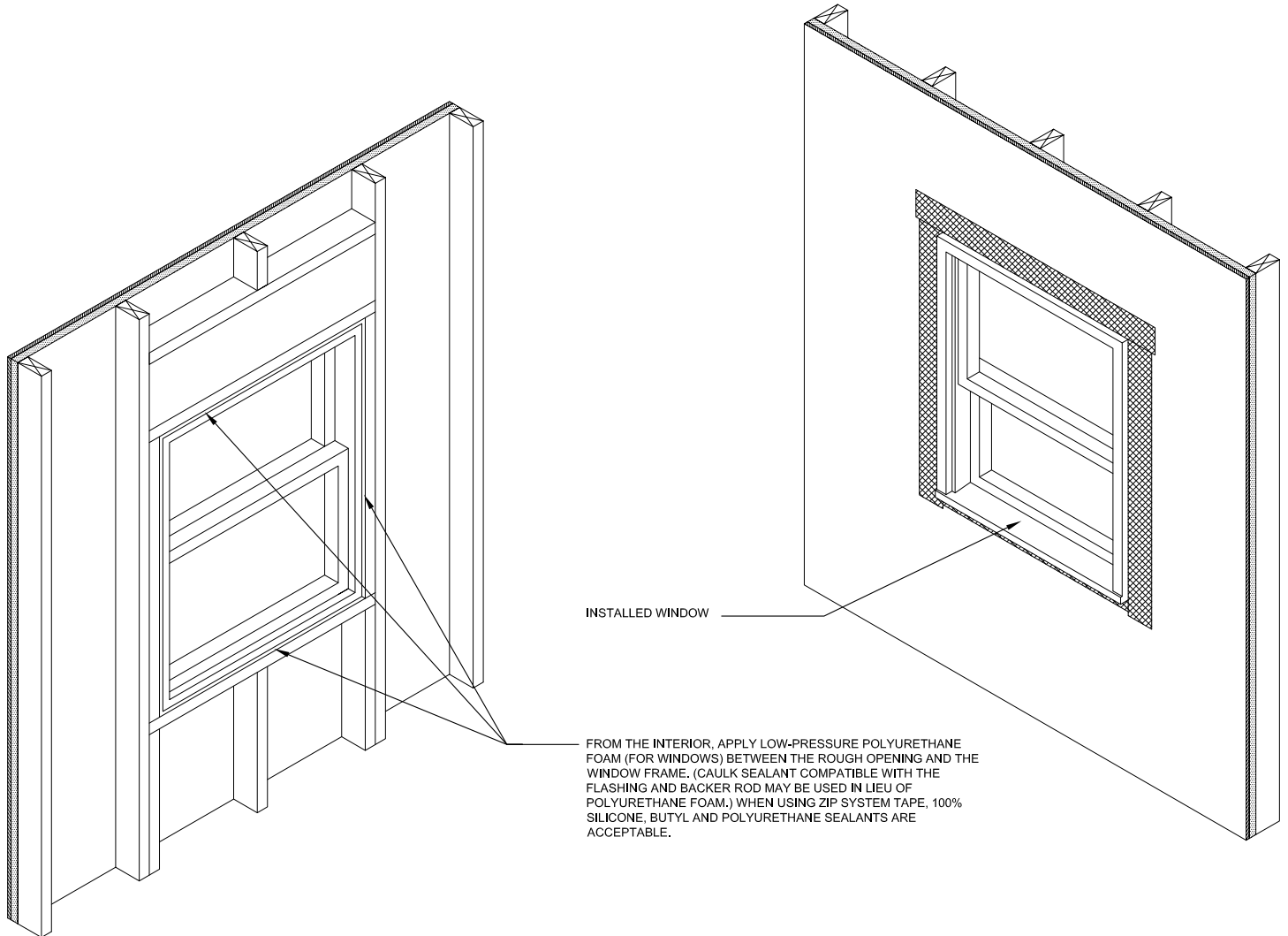

DRAWING NOT TO SCALE

07-09-2012

Sales Office: 10925 David Taylor Drive - Suite 300 - Charlotte, NC 28262  
Telephone: 800.933.9220 - Facsimile: 704.547.9228 - [www.zipsystem.com](http://www.zipsystem.com)

*another innovation from*



**ENGINEERED  
WOODS**

These construction details are provided to assist in the installation of ZIP System® product(s) and may not apply to every situation. Manufacturer accepts no responsibility or liability for the use of these or other construction details.