

WALL ASSEMBLY  
ZIP SYSTEM® SHEATHING  
WOOD OR LT. GAUGE METAL STUDS

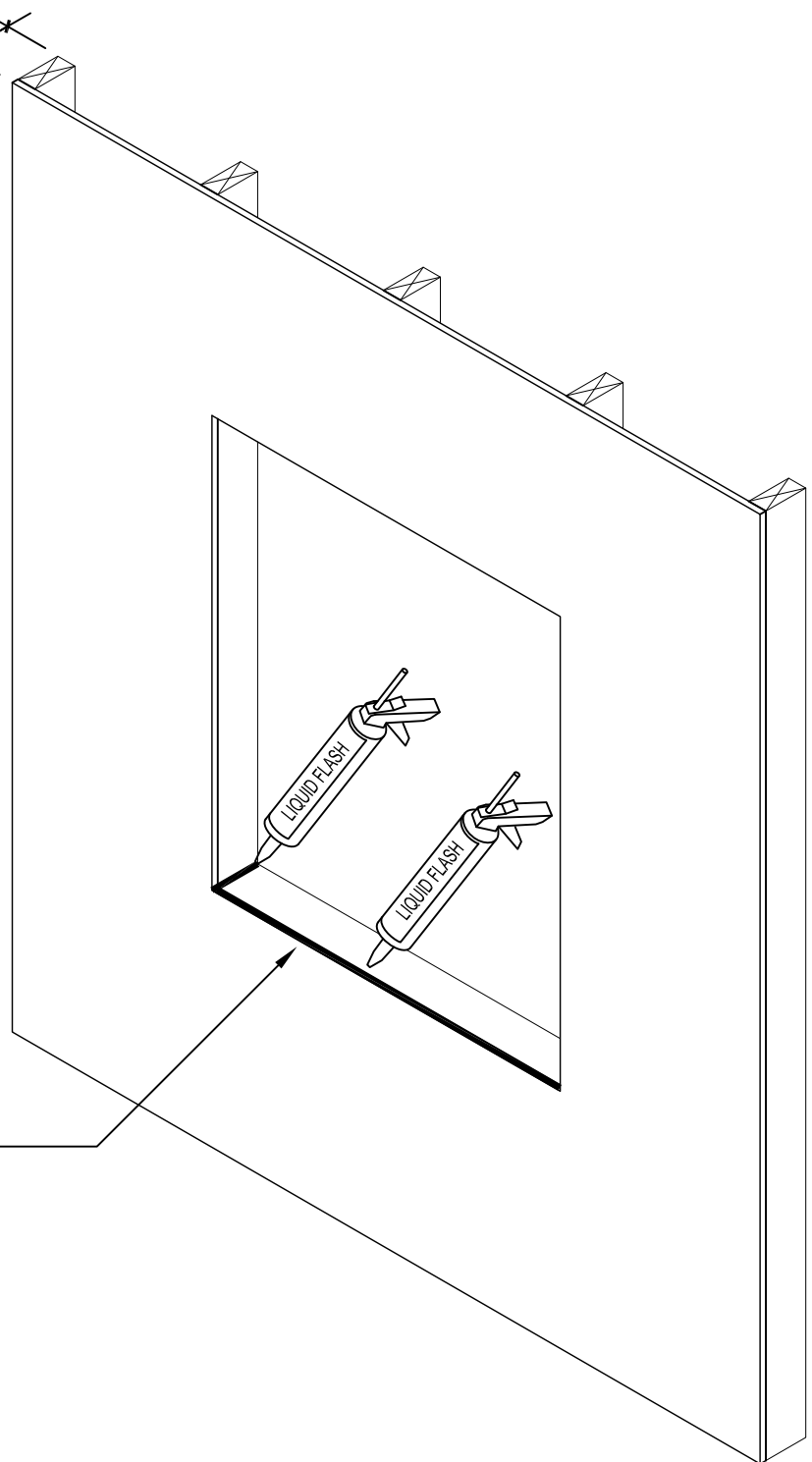

ENSURE ROUGH SILL HAS POSITIVE DRAINAGE TO THE EXTERIOR. APPLY A THICK BEAD OF ZIP SYSTEM LIQUID FLASH OVER ANY VISIBLE GAPS IN THE WINDOW ROUGH OPENING INCLUDING CORNERS AND WHERE THE SHEATHING MEETS THE FRAMING.

DRAWING NOT TO SCALE

07-09-2012

Sales Office: 10925 David Taylor Drive - Suite 300 - Charlotte, NC 28262  
Telephone: 800.933.9220 - Facsimile: 704.547.9228 - [www.zipsystem.com](http://www.zipsystem.com)

another innovation from



**ENGINEERED  
WOODS**

These construction details are provided to assist in the installation of ZIP System® product(s) and may not apply to every situation. Manufacturer accepts no responsibility or liability for the use of these or other construction details.

WALL ASSEMBLY  
ZIP SYSTEM® SHEATHING  
WOOD OR LT. GAUGE METAL STUDS

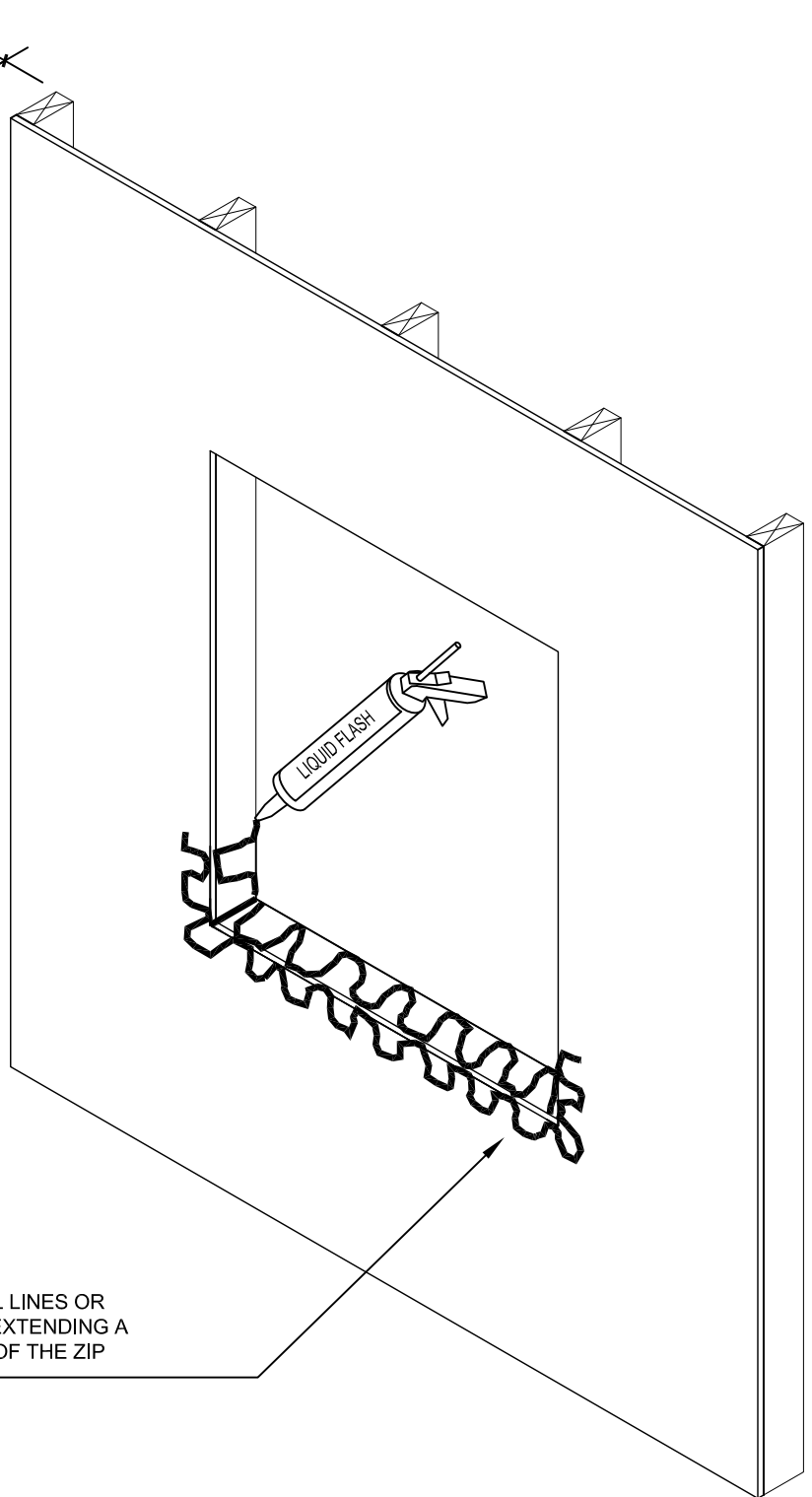

APPLY LIQUID FLASH IN STRAIGHT PARALLEL LINES OR ZIGZAG PATTERN TO THE ROUGH SILL AND EXTENDING A MINIMUM OF 2-INCHES OVER THE SURFACE OF THE ZIP SYSTEM WALL SURFACE.

DRAWING NOT TO SCALE

07-09-2012

Sales Office: 10925 David Taylor Drive - Suite 300 - Charlotte, NC 28262  
Telephone: 800.933.9220 - Facsimile: 704.547.9228 - [www.zipsystem.com](http://www.zipsystem.com)

*another innovation from*



**ENGINEERED  
WOODS**

These construction details are provided to assist in the installation of ZIP System® product(s) and may not apply to every situation. Manufacturer accepts no responsibility or liability for the use of these or other construction details.

WALL ASSEMBLY  
ZIP SYSTEM® SHEATHING  
WOOD OR LT. GAUGE METAL STUDS

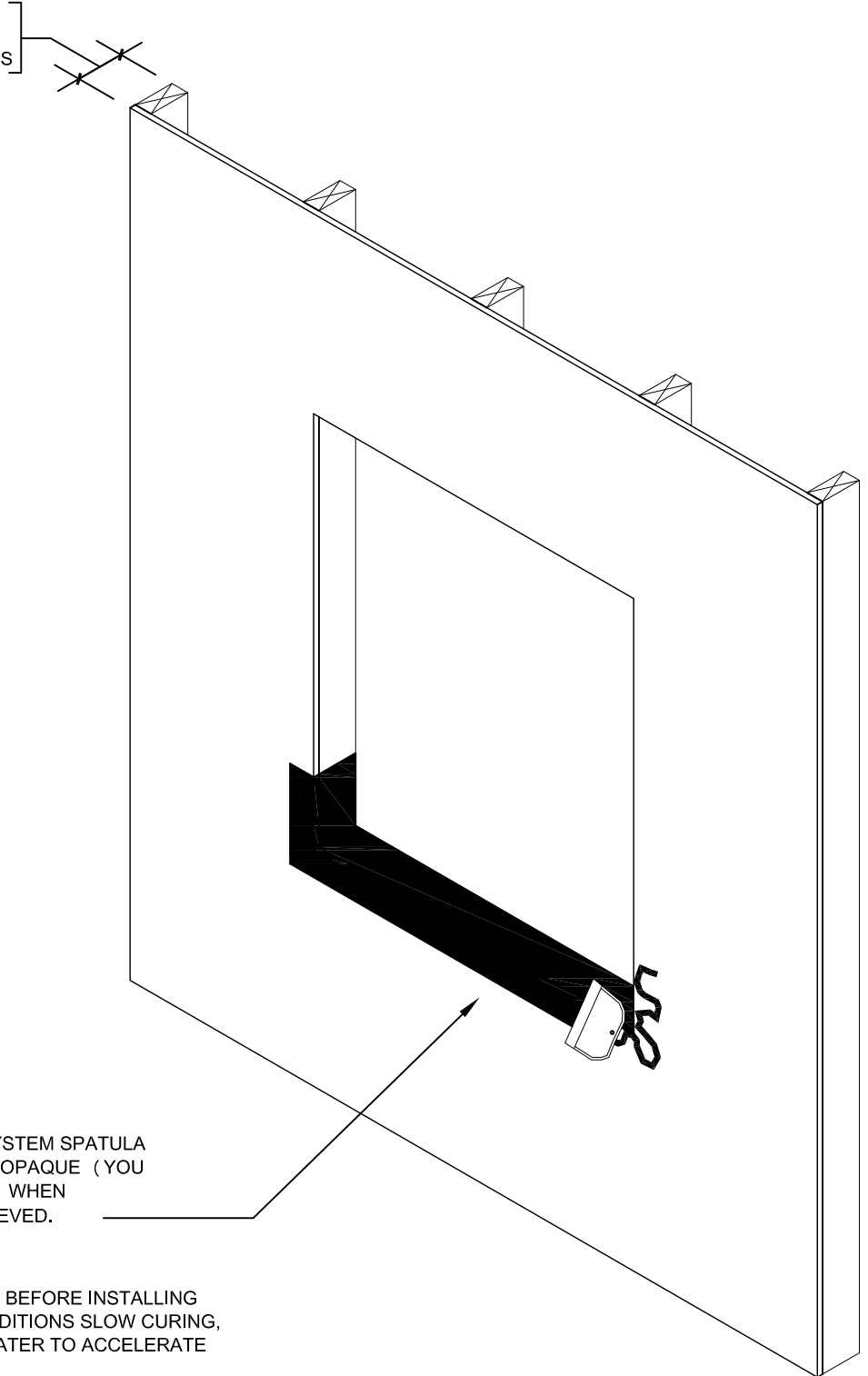

SMOOTH WET LIQUID FLASH USING A ZIP SYSTEM SPATULA OR SIMILAR TOOL. LIQUID FLASH BECOMES OPAQUE (YOU CAN'T SEE THE SUBSTRATE UNDERNEATH) WHEN MINIMUM THICKNESS OF 12-15 MILS IS ACHIEVED.

NOTE: ALLOW TREATED SURFACE TO CURE BEFORE INSTALLING WINDOWS. IF COLD OR DRY WEATHER CONDITIONS SLOW CURING, SURFACES MAY BE MISTED WITH FRESH WATER TO ACCELERATE THE CURE.

DRAWING NOT TO SCALE

07-09-2012

Sales Office: 10925 David Taylor Drive - Suite 300 - Charlotte, NC 28262  
Telephone: 800.933.9220 - Facsimile: 704.547.9228 - [www.zipsystem.com](http://www.zipsystem.com)

*another innovation from*



**ENGINEERED  
WOODS**

These construction details are provided to assist in the installation of ZIP System® product(s) and may not apply to every situation. Manufacturer accepts no responsibility or liability for the use of these or other construction details.

WALL ASSEMBLY  
ZIP SYSTEM® SHEATHING  
WOOD OR LT. GAUGE METAL STUDS

INSTALL WINDOW PER WINDOW  
MANUFACTURER'S INSTALLATION  
INSTRUCTIONS. VERIFY SEALANT  
COMPATIBILITY WITH WINDOW  
MANUFACTURER.

NOTE: WINDOW FLANGES SHOULD LAY  
FLAT AGAINST SHEATHING SURFACE IF  
LIQUID FLASH IS TO BE USED TO FLASH  
THE JAMBS AND HEAD AS SHOWN IN THE  
WINDOW FLASHING STEP. IF FLANGES DO  
NOT SIT FLAT, 6-INCH ZIP SYSTEM TAPE IS  
RECOMMENDED AS AN ALTERNATIVE.

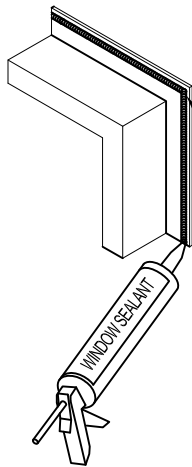

APPLY WINDOW SEALANT  
AROUND INSIDE FACE OF  
MOUNTING FLANGE. WINDOW  
SEALANT MUST BE GAPPED AT  
THE SILL TO PERMIT DRAINAGE.  
BUTYL, POLYURETHANE AND  
100% SILICONE SEALANTS ARE  
ACCEPTABLE WITH ZIP SYSTEM  
PRODUCTS. DO NOT USE LATEX  
CAULK OR ZIP SYSTEM LIQUID  
FLASH AS A WINDOW FLANGE  
SEALANT.

DRAWING NOT TO SCALE

07-09-2012

Sales Office: 10925 David Taylor Drive - Suite 300 - Charlotte, NC 28262  
Telephone: 800.933.9220 - Facsimile: 704.547.9228 - [www.zipsystem.com](http://www.zipsystem.com)

*another innovation from*



**ENGINEERED  
WOODS**

These construction details are provided to assist in the installation of ZIP System® product(s) and may not apply to every situation. Manufacturer accepts no responsibility or liability for the use of these or other construction details.

WALL ASSEMBLY  
ZIP SYSTEM® SHEATHING  
WOOD OR LT. GAUGE METAL STUDS

APPLY LIQUID FLASH IN STRAIGHT  
PARALLEL LINES OR ZIGZAG PATTERN  
AT THE JAMB AND HEAD FLANGES  
WITH A MINIMUM 1-INCH LAP ON TO  
PANEL SURFACE.

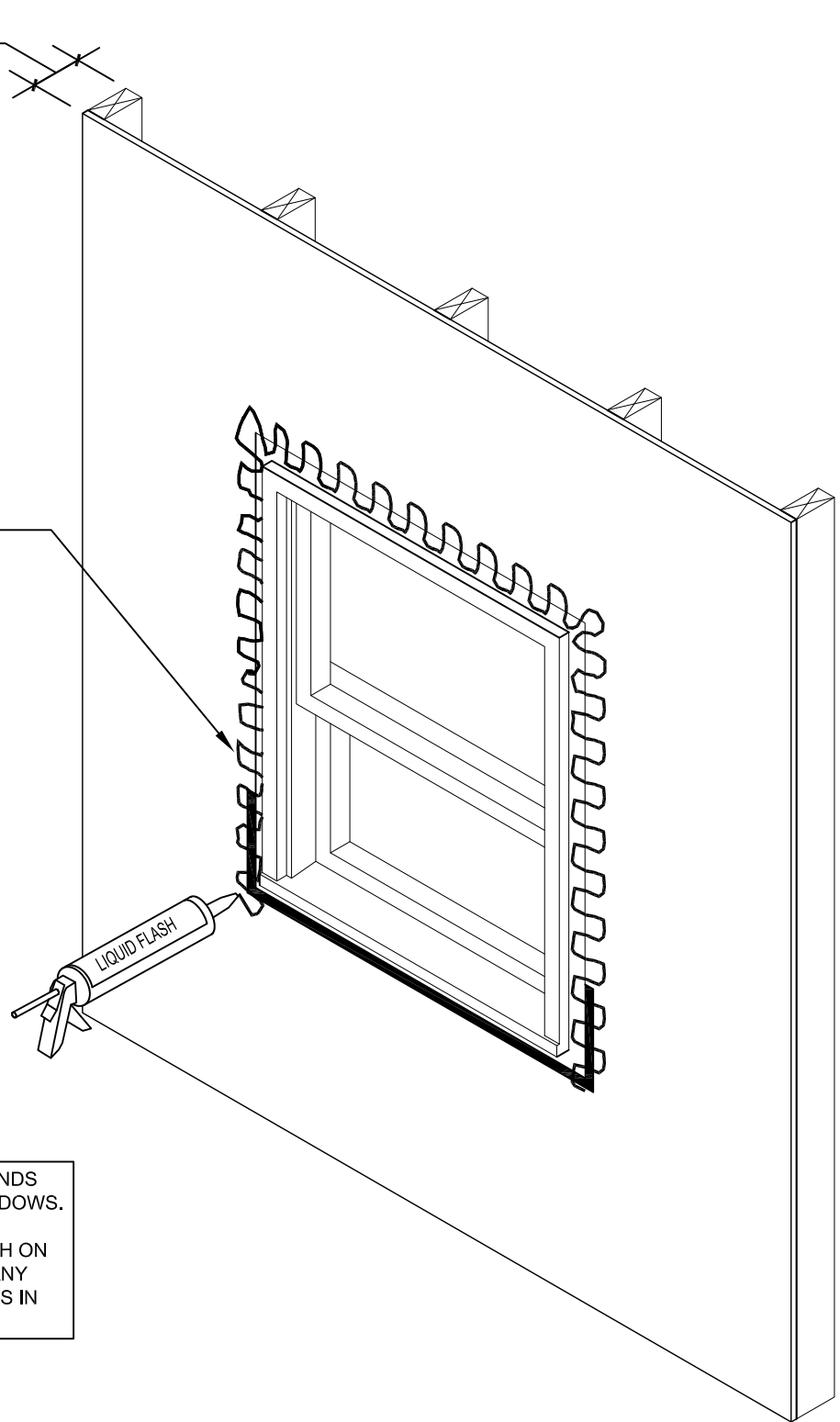

CAUTION: ZIP SYSTEM LIQUID FLASH BONDS  
AGGRESSIVELY TO VINYL FLANGED WINDOWS.  
INSTALLERS SHOULD TAKE NECESSARY  
PRECAUTIONS NOT TO GET LIQUID FLASH ON  
OUTSIDE FACE OF WINDOW. WIPE OFF ANY  
LIQUID FLASH IMMEDIATELY THAT COMES IN  
CONTACT WITH THE OUTSIDE FRAME.

DRAWING NOT TO SCALE

07-09-2012

Sales Office: 10925 David Taylor Drive - Suite 300 - Charlotte, NC 28262  
Telephone: 800.933.9220 - Facsimile: 704.547.9228 - [www.zipsystem.com](http://www.zipsystem.com)

another innovation from



ENGINEERED  
WOODS

These construction details are provided to assist in the installation of ZIP System® product(s) and may not apply to every situation. Manufacturer accepts no responsibility or liability for the use of these or other construction details.

WALL ASSEMBLY  
ZIP SYSTEM® SHEATHING  
WOOD OR LT. GAUGE METAL STUDS

SMOOTH WET PRODUCT USING ZIP SYSTEM SPATULA OR SIMILAR TOOL. LIQUID FLASH CAN SKIN QUICKLY IN HOT AND HUMID CONDITIONS SO ONLY APPLY ENOUGH THAT CAN BE SMOOTHED OUT BEFORE SKIN DEVELOPS.

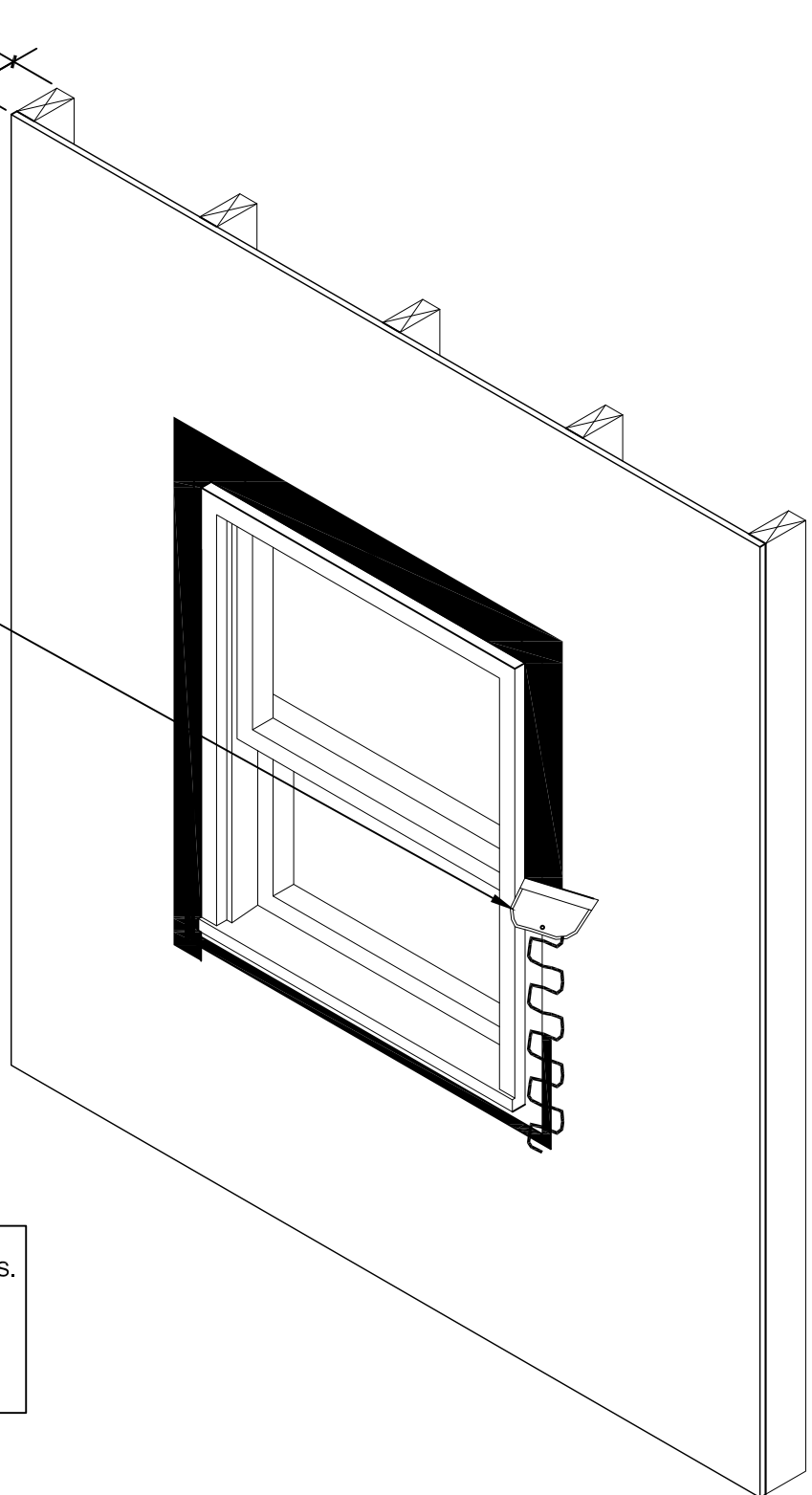

CAUTION: ZIP SYSTEM LIQUID FLASH BONDS AGGRESSIVELY TO VINYL FLANGED WINDOWS. INSTALLERS SHOULD TAKE NECESSARY PRECAUTIONS NOT TO GET LIQUID FLASH ON OUTSIDE FACE OF WINDOW. WIPE OFF ANY LIQUID FLASH IMMEDIATELY THAT COMES IN CONTACT WITH THE OUTSIDE FRAME.

DRAWING NOT TO SCALE

07-09-2012

Sales Office: 10925 David Taylor Drive - Suite 300 - Charlotte, NC 28262  
Telephone: 800.933.9220 - Facsimile: 704.547.9228 - [www.zipsystem.com](http://www.zipsystem.com)

another innovation from



ENGINEERED  
WOODS

These construction details are provided to assist in the installation of ZIP System® product(s) and may not apply to every situation. Manufacturer accepts no responsibility or liability for the use of these or other construction details.

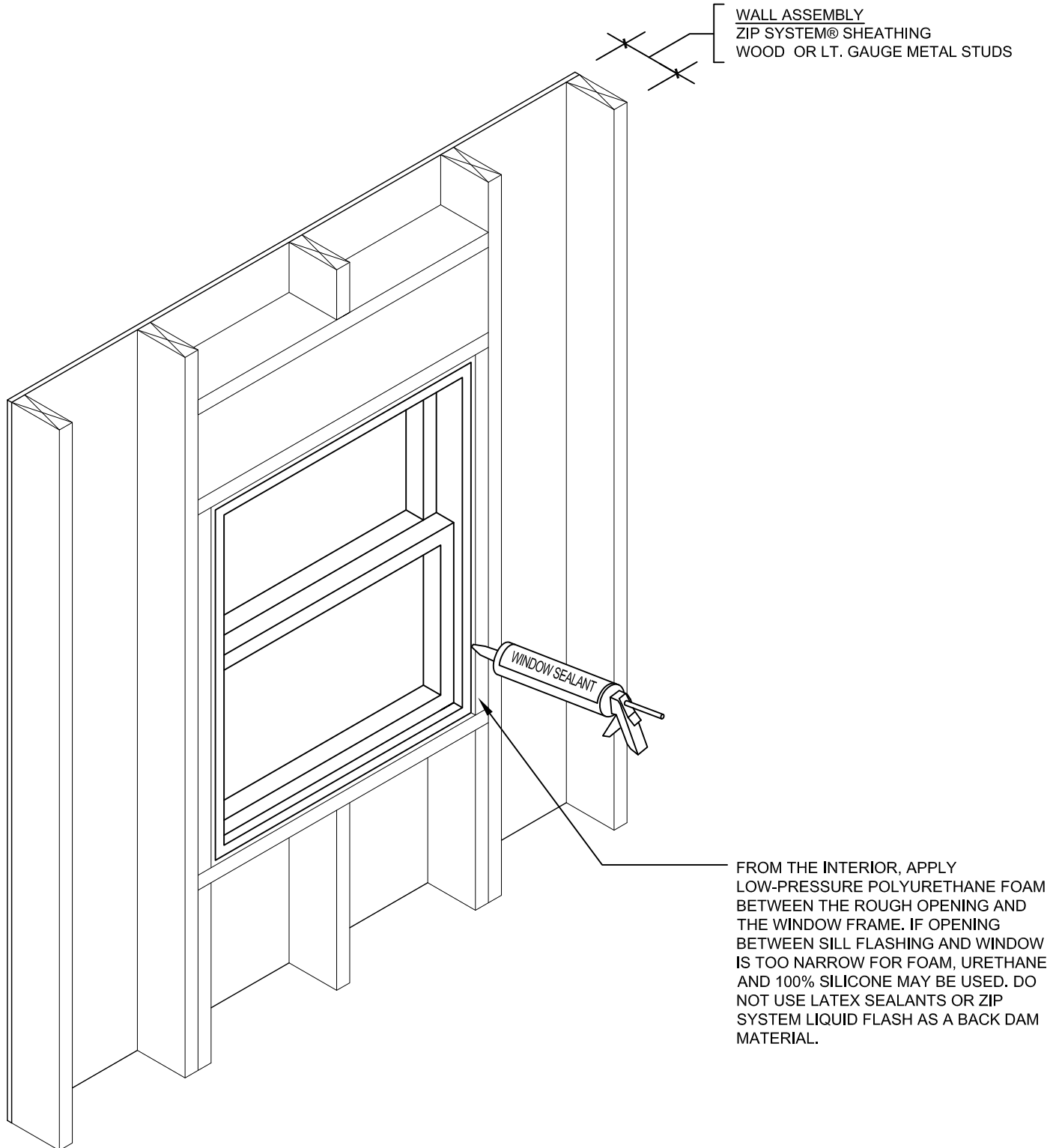

DRAWING NOT TO SCALE

07-09-2012

Sales Office: 10925 David Taylor Drive - Suite 300 - Charlotte, NC 28262  
Telephone: 800.933.9220 - Facsimile: 704.547.9228 - [www.zipsystem.com](http://www.zipsystem.com)

*another innovation from*



**ENGINEERED  
WOODS**

These construction details are provided to assist in the installation of ZIP System® product(s) and may not apply to every situation. Manufacturer accepts no responsibility or liability for the use of these or other construction details.