

ZIP SYSTEM® TAPE

MANUFACTURER

Huber Engineered Woods LLC

10925 David Taylor Drive, Suite 300, Charlotte, NC 28262
800.933.9220 • Technical Service: 800.933.9220 x2716
ZIPSystem.com • HuberArchitectLibrary.com

BASIC USE AND APPLICATIONS

ZIP System Tape is a code-recognized flashing tape for use at sheathing panel joints and around windows, door frames, wall penetrations and roof penetrations. Unlike most other flashing tapes, ZIP System Tape is compatible with flexible PVC windows.

ZIP System Tape transforms ZIP System Sheathing into a seamless protective barrier, providing superior air and moisture resistance to harsh elements. The combination of tape plus ZIP System Sheathing eliminates the need for a separate application of building wrap or roofing felt. Install the panels, tape the seams with ZIP System Tape, and the building is permanently weatherized.

ZIP System Tape has four layered components:

- Heat and UV resistant acrylic adhesive that forms a lifetime bond with the ZIP System Sheathing overlay
- Bonding layer that permanently joins the acrylic layer to the body of the tape
- Dimensionally stable inner layer of polyolefin that incorporates UV protection and antioxidants that make ZIP System Tape a lifetime product
- Slip resistant surface layer

ADVANTAGES

ZIP System Tape is a multi-purpose acrylic tape with a robust and aggressive adhesive. It's intertwined polymer chains provide excellent internal strength and durability. The tape's advanced acrylic adhesive is made of highly polar molecules; the resulting attraction pulls the adhesive into the ZIP System panels. This helps the tape wet out, flow into panel ridges and produce a permanent bond. The installation satisfies the requirements of AC148 and AAMA 711 as represented in ICC-ES ESR-2227.

The result is a superior, lasting seal that is considerably stronger than traditional asphalt and butyl tapes. ZIP System Tape also displays superior elongation, accommodating the normal expansion and contraction found in wood construction.

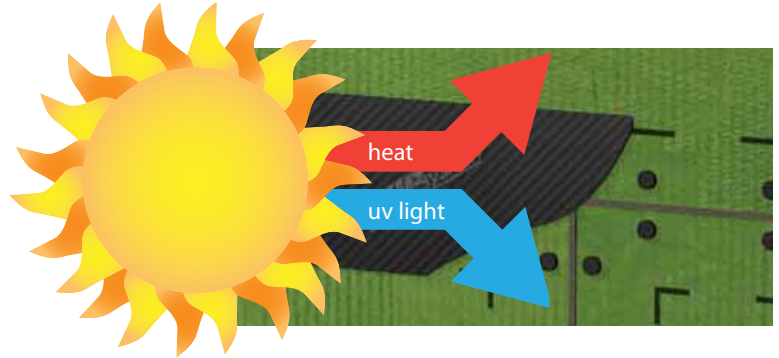

ZIP System Flashing Tape

Maximum Exposure Time	180 days
Adhesive Type	Acrylic
Cold Temperature Application	20 °F or above
Compatibility	Compatible with flexible PVC used in vinyl windows
Code Acceptance	IRC and IBC compliance recognized by ICC ESR-2227

The use of the tape as a flashing material is recognized for use on Type V construction under the IBC and non-fire-resistance-rated construction under the IBC and IRC.

SIZE

ZIP System Tape is available in 90 ft (27.4 m) long rolls in 3.75-inch (95.3 mm) and 6-inch (152 mm) roll widths. The 3.75-inch wide roll is produced with no release liner. The tape is also offered in individually packaged 6-inch (152 mm) by 75 ft (22.9 m) rolls with a split release liner in limited availability.

NOTES AND LIMITATIONS

ZIP System Tape is not considered a substitute for self-adhering ice and water barrier applications in roofing systems; when such materials are required, provide them in addition to application of tape.

APPLICATION

SUBSTRATE

Ensure that the tape substrate is dry and free of frost, dust, dirt, loose fasteners and other protrusions. Apply tape when ambient air and substrate are above 20 °F (-6 °C).

TAPE INSTALLATION

Refer to manufacturer's ZIP System Roof and Wall Sheathing Installation Manual for detailed instructions and illustrations for application of ZIP System Tape to sheathing, flanged windows, brick mould windows and penetration openings. Apply tape as additionally prescribed in ICC-ES ESR-2227, ESR-1473 and ESR-1474. Tape should be covered with a code-complying roof or wall covering within 180 days of installation. ZIP System Tape is a pressure-sensitive tape that must be rolled in (ZIP System tape roller or tape gun is recommended) to achieve maximum bond to the panel.

PANEL SEAMS

Apply tape over sheathing joints in manner described in manufacturer's written instructions, overlapping end joints a minimum of 3-inches (75 mm). Press tape firmly against substrate using tape gun or a rubber-faced roller; smooth tape until it conforms tightly to the substrate.

WINDOWS AND PENETRATIONS

Apply tape at sheathing penetrations as indicated in tape manufacturer's written instructions.

Apply tape at wall openings in manner described in window or door manufacturer's written instructions. Details of installation recommendations are available in AutoCAD and .pdf formats at ZIPSystem.com or HuberArchitectLibrary.com

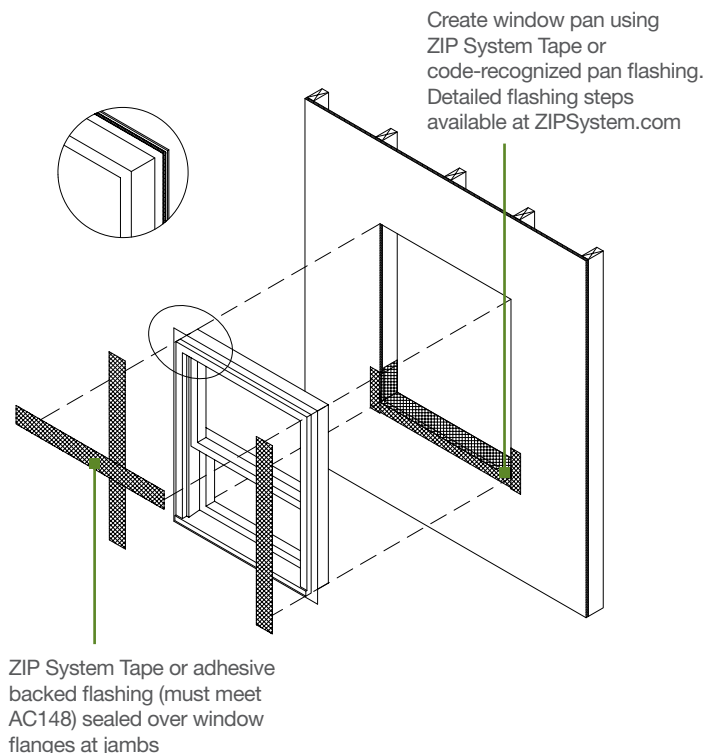

STORAGE AND HANDLING

Store ZIP System Tape in the original packaging at temperature not to exceed 90 °F (32 °C). Store in a clean, dry place.

When stored as recommended in its original unopened container, ZIP System Tape has a typical shelf life of 9 months from date of manufacture.

AVAILABILITY

Huber Engineered Wood's ZIP System Tape is available through distributors nationwide; visit ZIPSystem.com or contact Huber Engineered Woods for a retailer near you.

WARRANTY

ZIP System Tape is furnished with a 30-year system warranty when used with ZIP System Sheathing. See ZIPSystem.com for details.

TECHNICAL SERVICES

Detailed information including specifications, product literature, test reports, installation instructions and special applications is available through Huber Engineered Woods. Please visit ZIPSystem.com or call 800.933.9220 x2716 to speak to a technical representative.

AVAILABLE RESOURCES

Section 06 16 00 SHEATHING for ZIP System Roof and Wall Sheathing products in CSI 3-part format is available at ZIPSystem.com or HuberArchitectLibrary.com.

DRYER VENT PENETRATION

Install ZIP System Tape or adhesive backed flashing (must meet AC148) in sequence from bottom, sides, then top to ensure shingle lap of adhesive backed flashing

ZIP System Tape (installed over all joints in ZIP System Sheathing)

Use flanged vent hoods

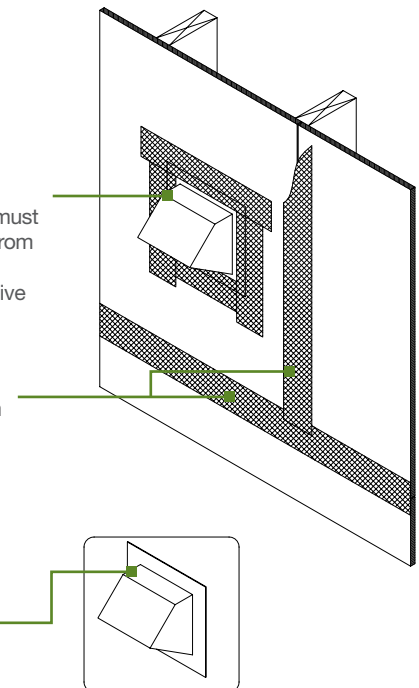

800.933.9220 • ZIPSystem.com