

# Installation Guide for Brick

**IMPORTANT:**  
Always refer to house  
wrap or building paper  
manufacturers install  
guidelines.

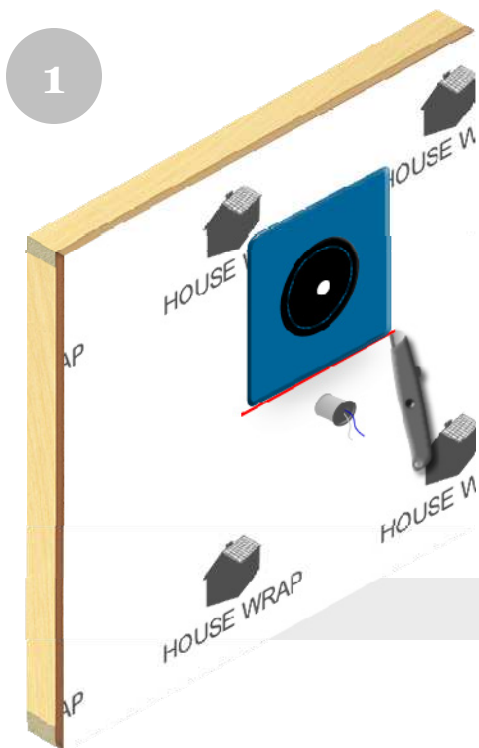
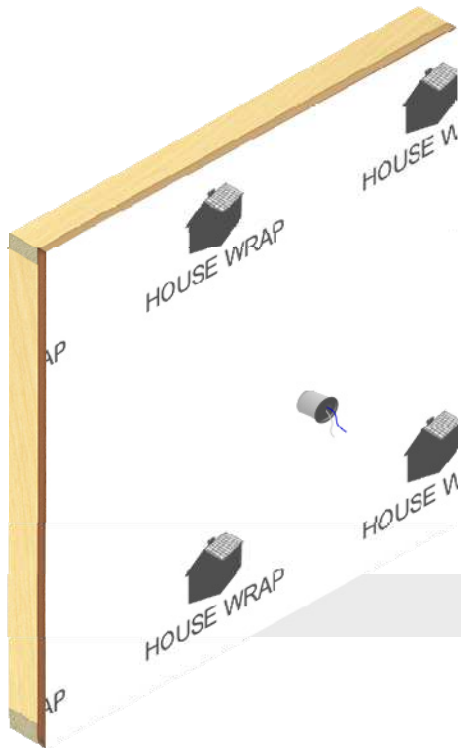

Using the Quickflash® panel as a guide, mark the length of the panel plus 1/4" on each side 2" above penetration onto the WRB and using a utility knife, cut a slit along the mark.

2

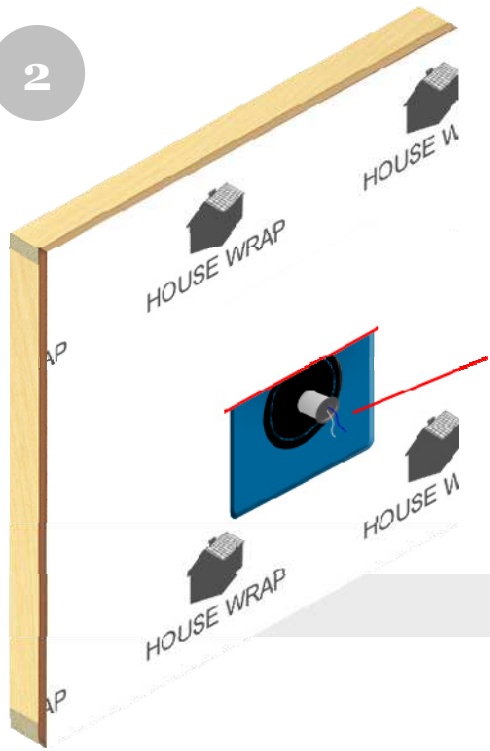

Slide the Quickflash® panel up underneath the WRB and over the penetration pressing down firmly to ensure a flush seal.

3

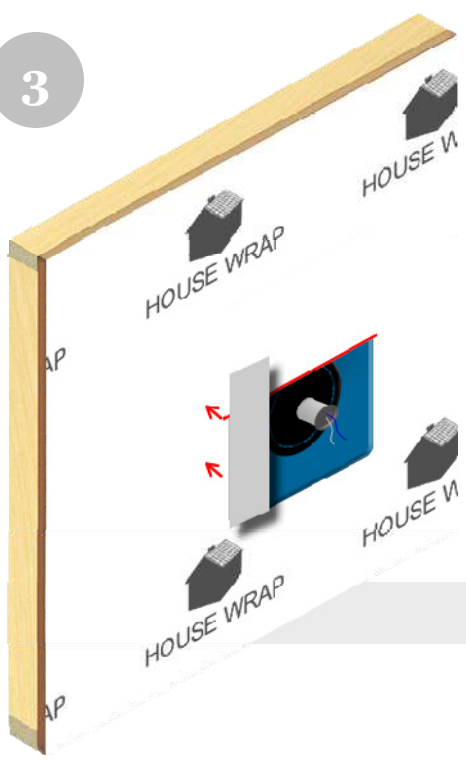

Tape on left side.

4

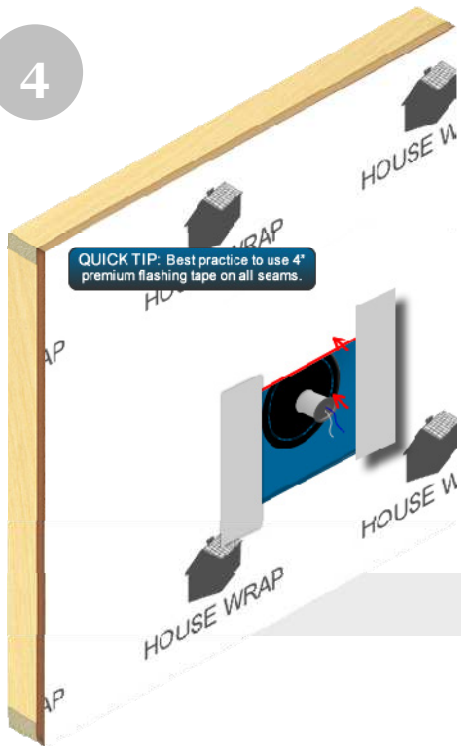

Tape on right side.

5

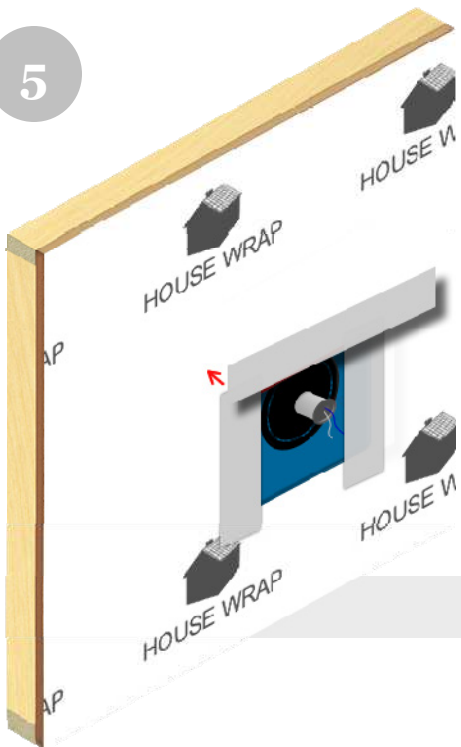

Tape across the top.

6

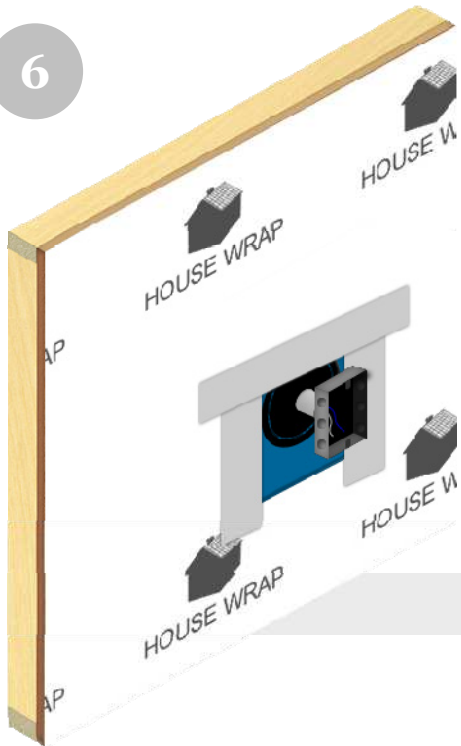

(If using for electrical)  
Attach electrical box to  
flexible conduit containing  
wire.

7

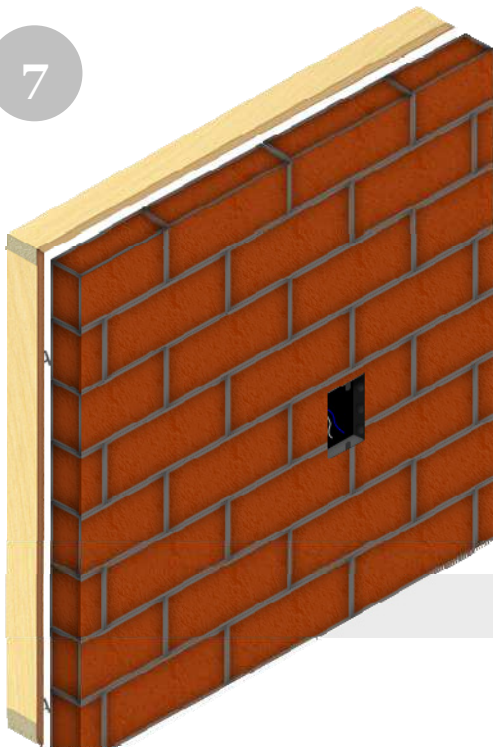

Install brick or cultured  
stone.