

## EXTREME WALL SYSTEMS: Superior R-Value

**EXTREME SIPs** provide significant savings in time & labor and are extremely energy efficient - resulting in high performance homes.

- **EPS FOAM** - Expanded Polystyrene, the closed cell foam between the OSB, is 100% recyclable, free of dyes, formaldehyde & HCFCs. Does not support mold or mildew growth.
- **CHEMICAL & OFF-GASSING** - To maintain high indoor air quality, the components of the SIPs panel are low or no VOC. It's comparable to the same level that naturally occurs in an apple.
- **STRENGTH** - SIPs historically have withstood natural disasters like hurricanes, earthquakes and tornadoes in the same areas where other building types have been destroyed.
- **OSB (ORIENTED STRAND BOARD)** - The interior and exterior skins of Extreme SIPs are produced from sustainably managed North American forests for SIP-Grade OSB. Extreme has incorporated Structure Shield<sup>+</sup> treated OSB into 100% of its wall and roof panel manufacturing. Structure Shield<sup>+</sup> yields the Ultimate Protection for your Extreme Structure.



### What is Superior R-Value?

**R-Value is a measure of how well a product “resists” the flow of heat or cold. The higher the R-Value the better. SIPs are 15 times tighter than conventional construction.**



- ◆ Zinc borate treatment is applied as a dry powder during the manufacturing process
- ◆ 25 year warranty compliments Extreme's impressive panel warranty
- ◆ Protects OSB against biological elements including fungal decay
- ◆ Ensures the long-term durability of OSB in regions where wood boring insects are prevalent
- ◆ Structure Shield<sup>+</sup> OSB is less expensive than pressure treated plywood

### EXTREME PANELS R-VALUES @ 25° F

SIP Thicknesses	R-value
4 1/2"	17
6 1/2"	26
8 1/4"	33
10 1/4"	42
12 1/4"	51

*Panel sizes available from  
4'x8' to 8'x24'*

# Extreme Panel

TECHNOLOGIES, INC.

## STRUCTURAL INSULATED PANELS

### STRUCTURAL INSULATED PANEL WALLS:

- ◆ Maintenance-free energy savings
- ◆ Superior R-Value
- ◆ Less labor cost to build
- ◆ Properly insulated without gaps, voids & compressions
- ◆ All window/door openings are pre-cut
- ◆ Pre-marked electrical chases, and special chases around doors
- ◆ 2.5 times STRONGER than a stick-framed house
- ◆ 15 times more air tight than conventional methods of construction
- ◆ Performs 50% to 70% better than Model Energy Code



### Electrical chases pre-cut in your wall panels

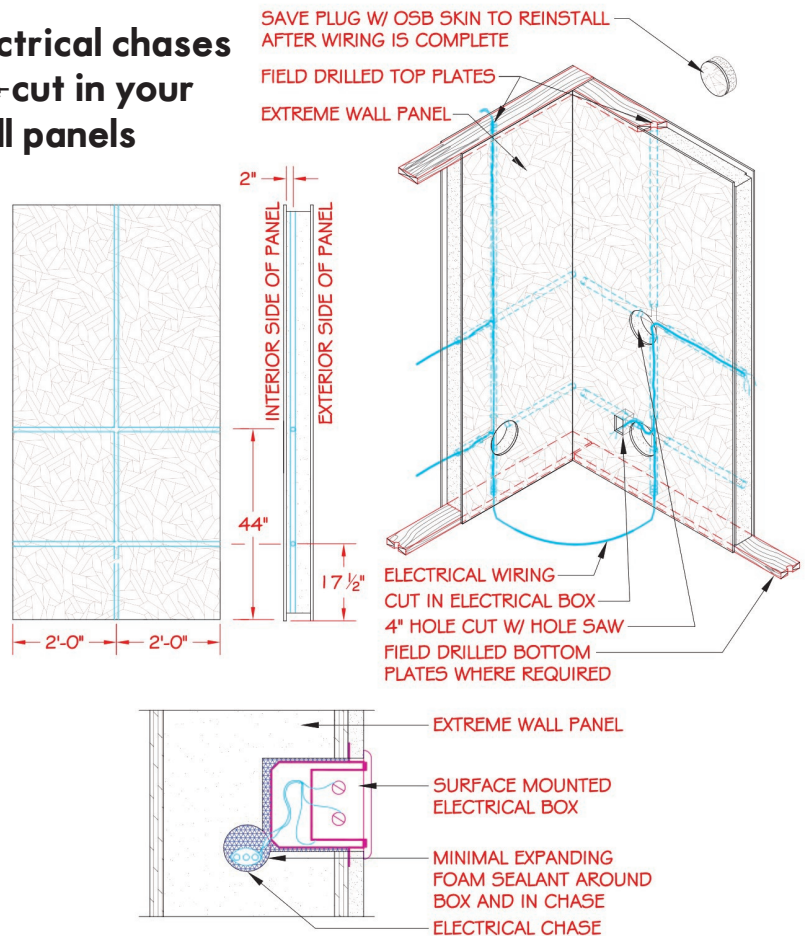

**EXTREME PANEL SIPs** are delivered to the jobsite pre-cut ready for assembly. The large wall and roof panels can be installed much like a puzzle. The fast installation not only saves time in the framing process, but the straight walls save time when hanging sheetrock, kitchen cabinets, etc.



475 East 4th St North • PO Box 435 • Cottonwood, MN 56229

800-977-2635 Fax: 507-423-5531

info@extremepanel.com

extremepanel.com

