



Project Profile

Hotel Lismore – Eau Claire, Wisconsin

DELTA®-VENT SA – Extra attention to the building envelope



→ General Information

Building Name	Hotel Lismore
Building Location	Eau Claire, Wisconsin
Country	USA
Project Size	20,000 ft ²
Building Type	Hotel
Project Type	Commercial
Type of Cladding	4 mm ACM "Dry-Set" Rainscreen Cladding
Total Building Costs	\$21 million (USD)
Owner	Pablo Properties
Architect	RSP Architects, Minneapolis
General Contractor	Market and Johnson Construction
Sub-Contractor for DELTA® Product	Division V Sheet Metal, Inc.
Year	2016



→ Project Description

As part of the continuing revitalization of downtown Eau Claire, Wisconsin, the boutique Lismore Hotel was redesigned and rebuilt in conjunction with the convention center. The inspiration for the hotel name was taken from Eau Claire's Australian sister city, Lismore, which is also located at the confluence of two rivers.

The owner, Pablo Properties, wanted the new hotel to be an asset to the downtown area and compliment the vibrant Farmers Market neighborhood. The Lismore features vintage hotel rooms and contemporary design that emphasizes a modern appearance while staying true to the Eau Claire community. The redesigned hotel will bring a new restaurant, coffee shop and bar to the downtown area.



The redeveloped downtown Eau Claire



Installation of rainscreen cladding

The owner's goal is to create a first class experience for the people of Eau Claire as well as visitors to their community, and they made a huge investment to ensure that they do it right. General contractors Market & Johnson stated that "The hotel is undergoing a major renovation and transformation. Every surface in the hotel will be rebuilt with new materials."

When the owners and RSP Architects were designing the property, they paid an extra level of attention to controlling the air and moisture in the building envelope. They were concerned about



The owners chose fully adhered DELTA®-VENT SA for a higher level of air and moisture control

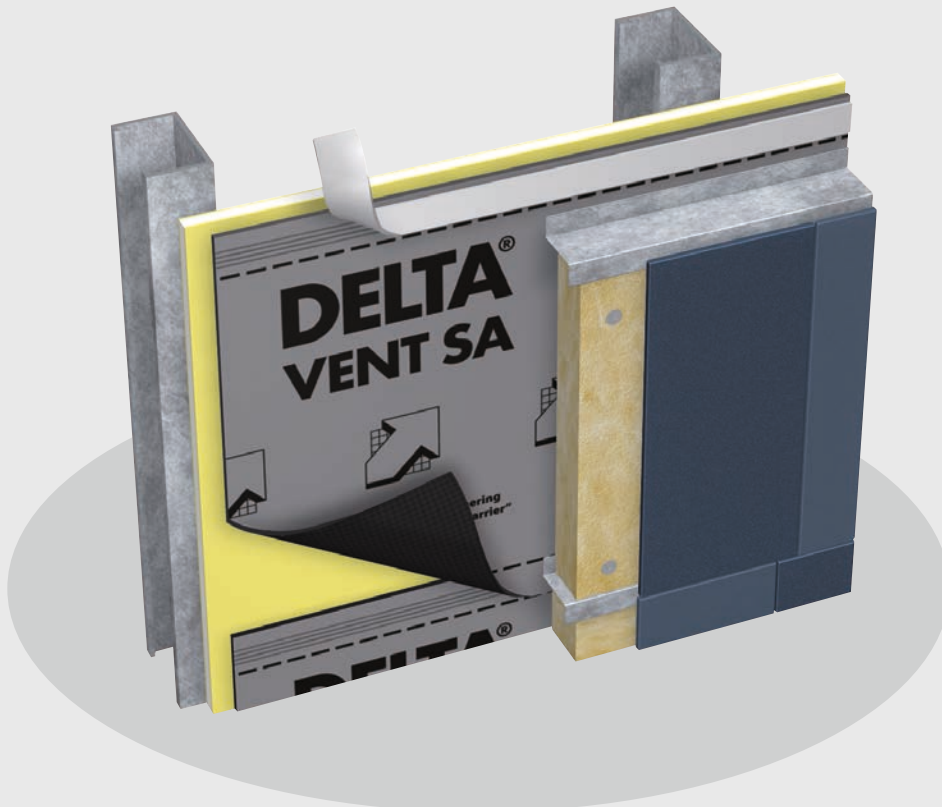

reducing operating costs as well as the comfort of their guests. They also wanted to ensure a long, trouble-free service life for the building in the Wisconsin environment that can be warm in the summer and quite cold in the winter.

An important part of the considerations was the type of air and moisture barrier they would use. Initially, the architect specified a fluid applied barrier over DensGlass® Gold. The contractor, Divison V Sheet Metal, Inc., was concerned about potential leaks at the seams in the DensGlass®, and therefore recommended DELTA®-VENT SA to the architect.

After considering how fully adhered DELTA®-VENT SA would eliminate any potential air leakage at the seams, the architect agreed. With this self-adhering air barrier membrane solution the risks associated with poor wall performance due to under- or over-spray in a fluid-applied barrier application were eliminated.